



Industrial Hygiene • Air Quality • Lead & Asbestos • Training • Health & Safety

LIMITED ASBESTOS INSPECTION REPORT

Conducted at:

JANSON ELEMENTARY SCHOOL
PAINTING PROJECT
8628 MARSHALL AVENUE
ROSEMEAD, CALIFORNIA 91770

Prepared for:

MR. HAROLD SULLINS
ASSISTANT SUPERINTENDENT
ROSEMEAD SCHOOL DISTRICT
3907 ROSEMEAD BOULEVARD, SUITE 220
ROSEMEAD, CALIFORNIA 91770

Prepared by:

EXECUTIVE ENVIRONMENTAL
310 EAST FOOTHILL BOULEVARD, SUITE 200
ARCADIA, CALIFORNIA 91006

Project Number EE 20-Z0046-0134
January 22, 2021

Report assembled by:

Yesenia G. Galeana
Technical Report Writer
Executive Environmental

Report generated/reviewed by:



Tim Galeana, CLP # 3732
Senior Project Manager
Executive Environmental

TABLE OF CONTENTS

- I. EXECUTIVE SUMMARY
- II. SAMPLING METHODOLOGY
- III. SAMPLE ANALYSIS
- IV. FINDINGS
- V. CONCLUSIONS/RECOMMENDATIONS
- VI. DISCLAIMER/REPORT LIMITATIONS

APPENDICES

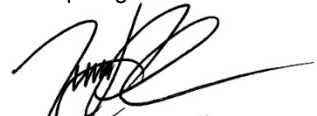
APPENDIX A – LABORATORY ANALYSIS REPORT

APPENDIX B – SAMPLE LOCATIONS DRAWINGS

APPENDIX C – STAFF CERTIFICATION

LIMITED ASBESTOS INSPECTION REPORT

Project Number: EE 20-Z0046-0134

Client: Rosemead School District
3907 Rosemead Boulevard, Suite 220
Rosemead, California 91770

Site Location: Janson Elementary School
Painting Project
8628 Marshall Avenue
Rosemead, California 91770

Site Use: School Property

Contact Person: Mr. Harold Sullins
Assistant Superintendent
Phone: (626) 312-2900

Inspection Date: November 9 through 12, 2020

Inspected By: Mr. Rhys Kuzmic
Certified Asbestos Consultant, # 09-4586

Report Assembled By: Ms. Yesenia G. Galeana
Technical Report Writer

Report Generated/Reviewed By: Mr. Tim Galeana
Certified Asbestos Consultant, # 98-2470

I. EXECUTIVE SUMMARY

Executive Environmental (EE) provided the services of a Certified Asbestos Consultant to conduct a limited asbestos inspection of the permanent buildings, portables and covered walkways at Janson Elementary School located at 8628 Marshall Avenue, Rosemead, California. The inspection was conducted as a precursor to the upcoming exterior painting project. Materials suspected of containing asbestos were sampled and analyzed for the presence of asbestos. No Asbestos-Containing Materials (ACM) were identified during this inspection. *This is considered to be a limited inspection. Inspection was limited to exterior materials anticipated to be impacted by the exterior painting project.*

II. SAMPLING METHODOLOGY

A visual inspection of the exterior of the permanent buildings, portables and covered walkways at Janson Elementary School was conducted prior to the collection of any bulk samples. The visual inspection was conducted to identify and record the location and condition of the materials to be sampled. Following the visual inspection, bulk material samples of the identified suspect asbestos-containing building materials were collected.

The materials were categorized into homogeneous groupings, and each sample was assigned a unique sample number and placed into a sealed container.

Upon completion of the bulk sample collection, a chain of custody was prepared and the samples were delivered to the laboratory for analysis. AmeriSci of Carson, CA, analyzed the samples using Polarized Light Microscopy (PLM). AmeriSci is an accredited participant in the National Voluntary Laboratory Accreditation Program (NVLAP), No. 200346-0. The principles described in the current Environmental Protection Agency (EPA) 600 method were used in the preparation and analysis of the bulk samples.

Note: Inaccessible suspect asbestos materials may be located within sealed ceilings, walls, or floors; or within wall cavities, interstitials, shafts, etc. Suspect asbestos materials located in these areas must be sampled prior to any activities that might cause them to be disturbed.

III. SAMPLE ANALYSIS

Eighty (80) samples were collected during this inspection. The laboratory analysis results are identified in the following table. Materials determined not to contain asbestos are listed as "No Asbestos Detected" (NAD).

Any material found to contain more than 1% of a known asbestos substance is considered to be an asbestos-containing material (ACM). Materials falling within this category are controlled and must be handled in accordance with the California Occupational Safety & Health Administration (Cal/OSHA), EPA, and South Coast Air Quality Management District (SCAQMD) regulations.

In addition, materials which are characterized as non-ACM by EPA or other local regulatory agencies may fall within the regulatory standards of Cal/OSHA, which further regulates any materials found to contain more than 1/10 of 1%, but 1% or less, of a known asbestos substance as asbestos-containing construction materials (ACCMs). Impacting or handling ACCMs requires special employer registration, documentation, training, and personal protective equipment. When a material is to be impacted, the National Emission Standards for Hazardous Air Pollutants (NESHAPs) regulations require further testing for materials that fall within this category.

The PLM analytical protocol requires each layer of the sample to be analyzed separately. The quantity of analyses will vary based on the number of layers in a sample and whether a "positive stop" is employed. When one sample of a homogeneous area is positive, the remainder of the samples need not be analyzed because the entire homogeneous area must be considered positive.

**Sampling results begin on the next page.
The remainder of this page is blank.**

POLARIZED LIGHT MICROSCOPY (PLM) ANALYSIS DATA

Janson Elementary School
8628 Marshall Avenue
Rosemead, California 91770

Homogeneous Material #	Material Description	Material Location	Estimated Quantity	Condition ^A	Type ^B	Friable	Percent Damaged	Sample Number	Sample Location	Analytical Results
Building A (Administration/Room 3) ^C										
1	Stucco	Throughout exterior walls	4,500 Square Feet	G	Surf.	No	<1	2011090134RK-01	West wall	NAD ^D
								2011090134RK-02	South wall	NAD
								2011090134RK-03	East wall	NAD
								2011090134RK-04	East wall at breezeway	NAD
								2011090134RK-05	North wall	NAD
Building B (Room 4) ^E										
2	Stucco	Throughout exterior walls and breezeway	2,700 Square Feet	G	Surf.	No	<1	2011090134RK-06	Breezeway ceiling, southwest	NAD
								2011090134RK-07	South wall	NAD
								2011090134RK-08	West wall	NAD
								2011090134RK-09	North wall	NAD
								2011090134RK-10	East wall	NAD

Note: This table must be used in conjunction with the entire report. This document is not to be used for contract bidding and is intended to be used to identify asbestos-containing materials and their locations only.

^A G = Good; D = Damaged; SD = Severely Damaged

^B Misc. = Miscellaneous; Surf. = Surfacing; TSI = Thermal System Insulation

^C NOTE: 1) Wood overhangs. 2) No window putty.

^D NAD = No Asbestos Detected.

^E NOTE: 1) Wood overhangs. 2) No window putty.

POLARIZED LIGHT MICROSCOPY (PLM) ANALYSIS DATA

Janson Elementary School
8628 Marshall Avenue
Rosemead, California 91770

Homogeneous Material #	Material Description	Material Location	Estimated Quantity	Condition ^F	Type ^G	Friable	Percent Damaged	Sample Number	Sample Location	Analytical Results
Building C (Multi-Purpose Building)^H										
3	Stucco	Throughout exterior walls	6,400 Square Feet	G	Surf.	No	<1	2011090134RK-11	South wall	<1% chrysotile ^I 1000-Pt. Ct.: NAD ^J
								2011090134RK-12	West wall, south end	<1% chrysotile 1000-Pt. Ct.: NAD
								2011090134RK-13	West wall, north end	<1% chrysotile 1000-Pt. Ct.: NAD
								2011090134RK-14	East wall	<1% chrysotile 1000-Pt. Ct.: <0.1% chrysotile
								2011090134RK-15	East wall, north end	<1% chrysotile 1000-Pt. Ct.: <0.1% chrysotile
								2011090134RK-16	North wall	<1% chrysotile 1000-Pt. Ct.: <0.1% chrysotile
								2011090134RK-17	East wall above Covered walkway no. 2	<1% chrysotile 1000-Pt. Ct.: <0.1% chrysotile

Note: This table must be used in conjunction with the entire report. This document is not to be used for contract bidding and is intended to be used to identify asbestos-containing materials and their locations only.

^F G = Good; D = Damaged; SD = Severely Damaged

^G Misc. = Miscellaneous; Surf. = Surfacing; TSI = Thermal System Insulation

^H NOTE: 1) Wood overhangs. 2) No window putty.

^I Samples 11 thru 17 that had a result of less than 1% chrysotile via PLM analysis were further analyzed via the 1000-point count method. The analysis by 1000-point count analysis revealed that under Cal/OSHA regulations the stucco is a non-regulated material.

^J NAD = No Asbestos Detected.

POLARIZED LIGHT MICROSCOPY (PLM) ANALYSIS DATA

Janson Elementary School
8628 Marshall Avenue
Rosemead, California 91770

Homogeneous Material #	Material Description	Material Location	Estimated Quantity	Condition ^K	Type ^L	Friable	Percent Damaged	Sample Number	Sample Location	Analytical Results
Building D (Classrooms 10 thru 12) ^M										
4	Stucco	Throughout exterior walls	3,000 Square Feet	G	Surf.	No	<1	2011090134RK-18	West wall	NAD ^N
								2011090134RK-19	North wall, west end	NAD
								2011090134RK-20	South wall	NAD
								2011090134RK-21	East wall	NAD
								2011090134RK-22	North wall, east end	NAD
Building D (Classrooms 13 thru 16) ^O										
5	Stucco	Throughout exterior walls and West Breezeway	3,500 Square Feet	G	Surf.	No	<1	2011120134RK-23	South wall	NAD
								2011120134RK-24	East wall	NAD
								2011120134RK-25	North wall	NAD
								2011120134RK-26	West wall	NAD
								2011120134RK-27	West breezeway ceiling, southeast	NAD

Note: This table must be used in conjunction with the entire report. This document is not to be used for contract bidding and is intended to be used to identify asbestos-containing materials and their locations only.

^K G = Good; D = Damaged; SD = Severely Damaged

^L Misc. = Miscellaneous; Surf. = Surfacing; TSI = Thermal System Insulation

^M NOTE: 1) Wood overhangs. 2) No window putty.

^N NAD = No Asbestos Detected.

^O NOTE: 1) Wood overhangs. 2) No window putty

POLARIZED LIGHT MICROSCOPY (PLM) ANALYSIS DATA

Janson Elementary School
8628 Marshall Avenue
Rosemead, California 91770

Homogeneous Material #	Material Description	Material Location	Estimated Quantity	Condition ^P	Type ^Q	Friable	Percent Damaged	Sample Number	Sample Location	Analytical Results
Building E (Classrooms 17 thru 19) ^R										
6	Stucco	Throughout exterior walls	3,000 Square Feet	G	Surf.	No	<1	2011120134RK-28	North wall, west end	NAD ^S
								2011120134RK-29	West wall	NAD
								2011120134RK-30	South wall	NAD
								2011120134RK-31	East wall	NAD
								2011120134RK-32	North wall, east end	NAD
Building F (Classrooms 20 thru 23) ^T										
7	Stucco	Throughout exterior walls and West Breezeway	3,500 Square Feet	G	Surf.	No	<1	2011120134RK-33	South wall	NAD
								2011120134RK-34	East wall	NAD
								2011120134RK-35	North wall	NAD
								2011120134RK-36	West wall	NAD
								2011120134RK-37	West breezeway ceiling, southeast	NAD

Note: This table must be used in conjunction with the entire report. This document is not to be used for contract bidding and is intended to be used to identify asbestos-containing materials and their locations only.

^P G = Good; D = Damaged; SD = Severely Damaged

^Q Misc. = Miscellaneous; Surf. = Surfacing; TSI = Thermal System Insulation

^R NOTE: 1) Wood overhangs. 2) No window putty.

^S NAD = No Asbestos Detected.

^T NOTE: 1) Wood overhangs. 2) No window putty.

POLARIZED LIGHT MICROSCOPY (PLM) ANALYSIS DATA

Janson Elementary School
8628 Marshall Avenue
Rosemead, California 91770

Homogeneous Material #	Material Description	Material Location	Estimated Quantity	Condition ^u	Type ^v	Friable	Percent Damaged	Sample Number	Sample Location	Analytical Results
Building H (Classrooms 5 thru 9)^w										
8	Stucco	Throughout exterior walls and Overhang	4,500 Square Feet	G	Surf.	No	<1	2011120134RK-38	South wall	NAD ^x
								2011120134RK-39	West wall	NAD
								2011120134RK-40	North wall	<1% chrysotile ^y
										1000-Pt. Ct.: <1% chrysotile
								2011120134RK-41	East wall	<1% chrysotile
										1000-Pt. Ct.: <1% chrysotile
								2011120134RK-42	Overhang, southeast	<1% chrysotile
										1000-Pt. Ct.: <1% chrysotile

Note: This table must be used in conjunction with the entire report. This document is not to be used for contract bidding and is intended to be used to identify asbestos-containing materials and their locations only.

^u G = Good; D = Damaged; SD = Severely Damaged

^v Misc. = Miscellaneous; Surf. = Surfacing; TSI = Thermal System Insulation

^w NOTE: 1) No window putty. 2) Exterior cinderblock and mortar not anticipated to be impacted during this Painting Project.

^x NAD = No Asbestos Detected.

^y Samples 40 thru 42 that had a result of less than 1% chrysotile via PLM analysis were further analyzed via the 1000-point count method. The analysis by 1000-point count analysis revealed that under Cal/OSHA regulations the stucco is a non-regulated material.

POLARIZED LIGHT MICROSCOPY (PLM) ANALYSIS DATA

Janson Elementary School
8628 Marshall Avenue
Rosemead, California 91770

Homogeneous Material #	Material Description	Material Location	Estimated Quantity	Condition ^Z	Type ^{AA}	Friable	Percent Damaged	Sample Number	Sample Location	Analytical Results
Restroom Building 1 ^{BB}										
9	Stucco	Throughout exterior walls and West Breezeway	1,200 Square Feet	G	Surf.	No	<1	2011120134RK-43	South wall	NAD ^{CC}
								2011120134RK-44	North wall	NAD
								2011120134RK-45	West wall	NAD
								2011120134RK-46	East wall	NAD
								2011120134RK-47	West breezeway ceiling, southeast	NAD
Restroom Building 2 ^{DD}										
10	Stucco	Throughout exterior walls and West Breezeway	1,200 Square Feet	G	Surf.	No	<1	2011120134RK-48	North wall	NAD
								2011120134RK-49	South wall	NAD
								2011120134RK-50	East wall	NAD
								2011120134RK-51	West wall	NAD
								2011120134RK-52	West breezeway ceiling, southeast	NAD

Note: This table must be used in conjunction with the entire report. This document is not to be used for contract bidding and is intended to be used to identify asbestos-containing materials and their locations only

^Z G = Good; D = Damaged; SD = Severely Damaged

^{AA} Misc. = Miscellaneous; Surf. = Surfacing; TSI = Thermal System Insulation

^{BB} NOTE: 1) Wood overhangs. 2) No window putty.

^{CC} NAD = No Asbestos Detected.

^{DD} NOTE: 1) Wood overhangs. 2) No window putty.

Executive Environmental
Limited Asbestos Inspection Report

Janson ES – Exterior Painting Project
Project Number EE 20-Z0046-0134
January 22, 2021

POLARIZED LIGHT MICROSCOPY (PLM) ANALYSIS DATA

Janson Elementary School
8628 Marshall Avenue
Rosemead, California 91770

Homogeneous Material #	Material Description	Material Location	Estimated Quantity	Condition ^{EE}	Type ^{FF}	Friable	Percent Damaged	Sample Number	Sample Location	Analytical Results
Covered Walkways ^{GG}										
11	Stucco	Covered walkway no. 7 walls	200 Square Feet	G	Surf.	No	<1	2011120134RK-53	East wall, north side	NAD ^{HH}
								2011120134RK-54	South side wall	NAD
								2011120134RK-55	West wall, south side	NAD
12	Stucco	Covered walkway no. 10 walls	200 Square Feet	G	Surf.	No	<1	2011120134RK-56	East wall, east side	NAD
								2011120134RK-57	East wall, south side	NAD
								2011120134RK-58	West wall, north side	NAD
Campus										
13	Asphalt paving	Kindergarten playground	2,700 Square Feet	G	Misc.	No	<1	2011120134RK-59	Southeast	NAD
								2011120134RK-60	Southwest	NAD
								2011120134RK-61	North	NAD
14	Asphalt paving	South playground	23,000 Square Feet	G	Misc.	No	<1	2011120134RK-62	Southeast	NAD
								2011120134RK-63	West of Building K (Room 25)	NAD
								2011120134RK-64	Center	NAD
								2011120134RK-65	Southwest	NAD
								2011120134RK-66	Northwest	NAD

Note: This table must be used in conjunction with the entire report. This document is not to be used for contract bidding and is intended to be used to identify asbestos-containing materials and their locations only

^{EE} G = Good; D = Damaged; SD = Severely Damaged

^{FF} Misc. = Miscellaneous; Surf. = Surfacing; TSI = Thermal System Insulation

^{GG} NOTE: 1) Covered walkways no. 1 thru 6, 8, 9, 11 and 12 have wood ceiling and metal poles.

^{HH} NAD = No Asbestos Detected.

POLARIZED LIGHT MICROSCOPY (PLM) ANALYSIS DATA

Janson Elementary School
8628 Marshall Avenue
Rosemead, California 91770

Homogeneous Material #	Material Description	Material Location	Estimated Quantity	Condition ^{II}	Type ^{JJ}	Friable	Percent Damaged	Sample Number	Sample Location	Analytical Results
Campus										
15	Asphalt paving	Driveway to South Parking Lot	3,900 Square Feet	G	Misc.	No	<1	2011120134RK-67	Northeast	NAD ^{KK}
								2011120134RK-68	Center	NAD
								2011120134RK-69	South	NAD
16	Texture coat	School sign at South Parking Lot	60 Square Feet	G	Misc.	No	<1	2011120134RK-70	On support post	NAD
								2011120134RK-71	On support post	NAD
								2011120134RK-72	On support post	NAD
17	Asphalt paving	South Parking Lot	33,000 Square Feet	G	Misc.	No	<1	2011120134RK-73	East	NAD
								2011120134RK-74	East	NAD
								2011120134RK-75	Center	NAD
								2011120134RK-76	Center-west	NAD
								2011120134RK-77	West	NAD
18	Texture coat	School sign north by Building A (Administration/Room 3)	60 Square Feet	G	Misc.	No	<1	2011120134RK-78	On support post	NAD
								2011120134RK-79	On support post	NAD
								2011120134RK-80	On support post	NAD

Note: This table must be used in conjunction with the entire report. This document is not to be used for contract bidding and is intended to be used to identify asbestos-containing materials and their locations only

^{II} G = Good; D = Damaged; SD = Severely Damaged

^{JJ} Misc. = Miscellaneous; Surf. = Surfacing; TSI = Thermal System Insulation

^{KK} NAD = No Asbestos Detected.

POLARIZED LIGHT MICROSCOPY (PLM) ANALYSIS DATA

Janson Elementary School
8628 Marshall Avenue
Rosemead, California 91770

Homogeneous Material #	Material Description	Material Location	Estimated Quantity	Condition ^{LL}	Type ^{MM}	Friable	Percent Damaged	Sample Number	Sample Location	Analytical Results
Portables ^{NN}										
No suspect asbestos-containing materials were identified on the exterior walls of Building J (Room 24), Building K (Room 25), Building O (Portable 42), Building P (Portable 43), Building L (Portables 26 thru 29 and Restroom), Building Q (Portables 30 thru 32), Building M (Portables 33 thru 37) and Building N (Portables 38 thru 41).										

Note: This table must be used in conjunction with the entire report. This document is not to be used for contract bidding and is intended to be used to identify asbestos-containing materials and their locations only.

The remainder of this page is blank.

^{LL} G = Good; D = Damaged; SD = Severely Damaged

^{MM} Misc. = Miscellaneous; Surf. = Surfacing; TSI = Thermal System Insulation

^{NN} NOTE: 1)All Portables have exterior wood walls and metal components.

IV. FINDINGS

EE conducted a limited asbestos inspection of the permanent buildings, portables and covered walkways at Janson Elementary School located at 8628 Marshall Avenue, Rosemead, California.

Eighteen (18) homogeneous material groups were identified during the visual property inspection. Eighty (80) samples of suspect asbestos-containing materials were collected and delivered to AmeriSci of Carson, CA for analysis. The homogeneous area and sampling results are listed on the table in Section III.

The analytical data revealed that the sampled materials do not contain asbestos.

V. CONCLUSIONS/RECOMMENDATIONS

No asbestos-containing materials were identified during this inspection. Activities involving the inspected materials may proceed as normal construction actions. If suspect asbestos materials that were not sampled are to be disturbed, additional sampling will be required.

If you have any questions, please call Mr. Tim Galeana at 626-441-7050. We are glad we could be of service to you.

VI. DISCLAIMER/REPORT LIMITATIONS

All reports and recommendations are based on conditions and practices observed and information made available to Executive Environmental (EE) by the client and the designated sites/facilities on the days sampling was conducted. This report does not purport to set forth all hazards, nor to indicate that other hazards do not exist. No responsibility is assumed by EE for the control or correction of conditions or practices existing at the facilities, or at any other premises surveyed by EE, for and on the behalf of the client. Services provided by EE shall be governed by the standard of practice for professional services measured at the time those services are rendered.

All information contained in this report is proprietary and limited to the scope of services, parameters of the analytical methods used and the conditions present at the time of this inspection. Any references to quantities are considered estimates and are not to be construed as actual.

APPENDIX A – LABORATORY ANALYSIS REPORT



Please Reply To:

AmeriSci Los Angeles

24416 S. Main Street, Ste 308

Carson, California 90745

TEL: (310) 834-4868 • FAX: (310) 834-4772

FACSIMILE TELECOPY TRANSMISSION

To: Yesenia Galeana Executive Environmental Services Corporation	From: Kristina Martinez AmeriSci Job #: 920111158
Fax #:	Subject: PLM 3 day Results
Email: info@execenv.com, ygaleana@execenv.com	Client Project: 20-Z0046-0134; Building A (Admin / Room 3), Building B (Room 4), Building C (MP

Date: Thursday, November 12, 2020

Time: 20:45:00

Comments:

Number of Pages:

10
(including cover sheet)

CONFIDENTIALITY NOTICE: Unless otherwise indicated, the information contained in this communication is confidential information intended for use of the individual named above. If the reader of this communication is not the intended recipient, you are hereby notified that any dissemination, distribution or copying of this communication is prohibited. If you have received this communication in error, please immediately notify the sender by telephone and return the original message to the above address via the US Postal Service at our expense. Samples are disposed of in 60 days or unless otherwise instructed by the protocol or special instructions in writing. Thank you.

Certified Analysis Service 24 Hours A Day • 7 Days A Week Competitive Prices
visit our web site - www.amerisci.com

Boston • Los Angeles • New York • Richmond

**AmeriSci Los Angeles**

24416 S. Main Street, Ste 308

Carson, California 90745

TEL: (310) 834-4868 • FAX: (310) 834-4772

PLM Bulk Asbestos Report

Executive Environmental Services Corpo **Date Received** 11/10/20 **AmeriSci Job #** 920111158
Attn: Yesenia Galeana **Date Examined** 11/12/20 **P.O. #**
310 East Foothill Blvd. **Page** 1 **of** 5
Suite 200 **RE: 20-Z0046-0134; Building A (Admin / Room 3), Building B**
Arcadia, CA 91006 **(Room 4), Building C (MPR), Building D (Rooms 10-12)**

Client No. / HGA	Lab No.	Asbestos Present	Total % Asbestos
2011090134RK-01 Location: Exterior, West Wall / Exterior Stucco / T-O Exterior Walls Analyst Description: White/Grey, Heterogeneous, Non-Fibrous, Cementitious, Stucco Asbestos Types: Other Material: Non-fibrous 100 %	920111158-01	No	NAD (by CVES) by Kristina Martinez on 11/12/20
2011090134RK-02 Location: Exterior, South Wall / Exterior Stucco Analyst Description: White/Grey, Heterogeneous, Non-Fibrous, Cementitious, Stucco Asbestos Types: Other Material: Non-fibrous 100 %	920111158-02	No	NAD (by CVES) by Kristina Martinez on 11/12/20
2011090134RK-03 Location: Exterior, East Wall / Exterior Stucco Analyst Description: White/Grey, Heterogeneous, Non-Fibrous, Cementitious, Stucco Asbestos Types: Other Material: Non-fibrous 100 %	920111158-03	No	NAD (by CVES) by Kristina Martinez on 11/12/20
2011090134RK-04 Location: Exterior, East Wall At Breezeway / Exterior Stucco Analyst Description: White/Grey, Heterogeneous, Non-Fibrous, Cementitious, Stucco Asbestos Types: Other Material: Non-fibrous 100 %	920111158-04	No	NAD (by CVES) by Kristina Martinez on 11/12/20
2011090134RK-05 Location: Exterior, North Wall / Exterior Stucco Analyst Description: White/Grey, Heterogeneous, Non-Fibrous, Cementitious, Stucco Asbestos Types: Other Material: Non-fibrous 100 %	920111158-05	No	NAD (by CVES) by Kristina Martinez on 11/12/20

Client Name: Executive Environmental Services Corporation

PLM Bulk Asbestos Report20-Z0046-0134; Building A (Admin / Room 3), Building B
(Room 4), Building C (MPR), Building D (Rooms 10-12)

Client No. / HGA	Lab No.	Asbestos Present	Total % Asbestos
2011090134RK-06	920111158-06	No	NAD
Location: Exterior, Breezeway Ceiling SW / Exterior Stucco / T-O Exterior Walls And Breezeway Analyst Description: White/Grey, Heterogeneous, Non-Fibrous, Cementitious, Stucco Asbestos Types: Other Material: Non-fibrous 100 %			(by CVES) by Kristina Martinez on 11/12/20
2011090134RK-07	920111158-07	No	NAD
Location: Exterior, South Wall / Exterior Stucco Analyst Description: White/Grey, Heterogeneous, Non-Fibrous, Cementitious, Stucco Asbestos Types: Other Material: Non-fibrous 100 %			(by CVES) by Kristina Martinez on 11/12/20
2011090134RK-08	920111158-08	No	NAD
Location: Exterior, West Wall / Exterior Stucco Analyst Description: White/Grey, Heterogeneous, Non-Fibrous, Cementitious, Stucco Asbestos Types: Other Material: Non-fibrous 100 %			(by CVES) by Kristina Martinez on 11/12/20
2011090134RK-09	920111158-09	No	NAD
Location: Exterior, North Wall / Exterior Stucco Analyst Description: White/Grey, Heterogeneous, Non-Fibrous, Cementitious, Stucco Asbestos Types: Other Material: Non-fibrous 100 %			(by CVES) by Kristina Martinez on 11/12/20
2011090134RK-10	920111158-10	No	NAD
Location: Exterior, East Wall / Exterior Stucco Analyst Description: White/Grey, Heterogeneous, Non-Fibrous, Cementitious, Stucco Asbestos Types: Other Material: Non-fibrous 100 %			(by CVES) by Kristina Martinez on 11/12/20
2011090134RK-11	920111158-11	Yes	Trace (<1 %)
Location: Exterior, South Wall / Exterior Stucco / T-O Exterior Walls Analyst Description: Beige/Grey, Heterogeneous, Non-Fibrous, Cementitious, Stucco Asbestos Types: Chrysotile <1. % Other Material: Non-fibrous 100 %			(by CVES) by Kristina Martinez on 11/12/20

Client Name: Executive Environmental Services Corporation

PLM Bulk Asbestos Report20-Z0046-0134; Building A (Admin / Room 3), Building B
(Room 4), Building C (MPR), Building D (Rooms 10-12)

Client No. / HGA	Lab No.	Asbestos Present	Total % Asbestos
2011090134RK-12 Location: Exterior, West Wall - South End / Exterior Stucco Analyst Description: Beige/Grey, Heterogeneous, Non-Fibrous, Cementitious, Stucco Asbestos Types: Chrysotile <1. % Other Material: Non-fibrous 100 %	920111158-12	Yes	Trace (<1 %) (by CVES) by Kristina Martinez on 11/12/20
2011090134RK-13 Location: Exterior, West Wall - North End / Exterior Stucco Analyst Description: Beige/Grey, Heterogeneous, Non-Fibrous, Cementitious, Stucco Asbestos Types: Chrysotile <1. % Other Material: Non-fibrous 100 %	920111158-13	Yes	Trace (<1 %) (by CVES) by Kristina Martinez on 11/12/20
2011090134RK-14 Location: Exterior, East Wall / Exterior Stucco Analyst Description: Beige/Grey, Heterogeneous, Non-Fibrous, Cementitious, Stucco Asbestos Types: Chrysotile <1. % Other Material: Non-fibrous 100 %	920111158-14	Yes	Trace (<1 %) (by CVES) by Kristina Martinez on 11/12/20
2011090134RK-15 Location: Exterior, East Wall - North End / Exterior Stucco Analyst Description: Beige/Grey, Heterogeneous, Non-Fibrous, Cementitious, Stucco Asbestos Types: Chrysotile <1. % Other Material: Cellulose 100 %	920111158-15	Yes	Trace (<1 %) (by CVES) by Kristina Martinez on 11/12/20
2011090134RK-16 Location: Exterior, North Wall / Exterior Stucco Analyst Description: Beige/Grey, Heterogeneous, Non-Fibrous, Cementitious, Stucco Asbestos Types: Chrysotile <1. % Other Material: Non-fibrous 100 %	920111158-16	Yes	Trace (<1 %) (by CVES) by Kristina Martinez on 11/12/20
2011090134RK-17 Location: Exterior, East Wall Above Covered Walkway 2 / Exterior Stucco Analyst Description: Beige/Grey, Heterogeneous, Non-Fibrous, Cementitious, Stucco Asbestos Types: Chrysotile <1. % Other Material: Non-fibrous 100 %	920111158-17	Yes	Trace (<1 %) (by CVES) by Kristina Martinez on 11/12/20

Client Name: Executive Environmental Services Corporation

PLM Bulk Asbestos Report20-Z0046-0134; Building A (Admin / Room 3), Building B
(Room 4), Building C (MPR), Building D (Rooms 10-12)

Client No. / HGA	Lab No.	Asbestos Present	Total % Asbestos
2011090134RK-18	920111158-18	No	NAD
Location: Exterior, West Wall / Exterior Stucco / T-O Exterior Walls			(by CVES) by Kristina Martinez on 11/12/20
Analyst Description: White/Grey, Heterogeneous, Non-Fibrous, Cementitious, Stucco			
Asbestos Types:			
Other Material: Non-fibrous 100 %			
2011090134RK-19	920111158-19	No	NAD
Location: Exterior, North Wall - West End / Exterior Stucco			(by CVES) by Kristina Martinez on 11/12/20
Analyst Description: White/Grey, Heterogeneous, Non-Fibrous, Cementitious, Stucco			
Asbestos Types:			
Other Material: Non-fibrous 100 %			
2011090134RK-20	920111158-20	No	NAD
Location: Exterior, South Wall / Exterior Stucco			(by CVES) by Kristina Martinez on 11/12/20
Analyst Description: White/Grey, Heterogeneous, Non-Fibrous, Cementitious, Stucco			
Asbestos Types:			
Other Material: Non-fibrous 100 %			
2011090134RK-21	920111158-21	No	NAD
Location: Exterior, East Wall / Exterior Stucco			(by CVES) by Kristina Martinez on 11/12/20
Analyst Description: White/Grey, Heterogeneous, Non-Fibrous, Cementitious, Stucco			
Asbestos Types:			
Other Material: Non-fibrous 100 %			
2011090134RK-22	920111158-22	No	NAD
Location: Exterior, North Wall - East End / Exterior Stucco			(by CVES) by Kristina Martinez on 11/12/20
Analyst Description: White/Grey, Heterogeneous, Non-Fibrous, Cementitious, Stucco			
Asbestos Types:			
Other Material: Non-fibrous 100 %			

Client Name: Executive Environmental Services Corporation

PLM Bulk Asbestos Report

20-Z0046-0134; Building A (Admin / Room 3), Building B
(Room 4), Building C (MPR), Building D (Rooms 10-12)

Reporting Notes:

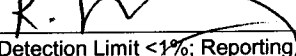
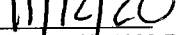
Analyzed By: Kristina Martinez ; Date Analyzed: 11/12/2020 
*NAD = no asbestos detected; Detection Limit <1%; Reporting Limits: CVES = 1%, 400 Pt Ct = 0.25%, 1000 Pt Ct = 0.1%; NA = not analyzed; NA/PS = not analyzed / positive stop; NVA = No Visible Asbestos; PLM (polarized light microscopy) Bulk Asbestos Analysis by EPA 600/R-93/116, including requirements for EPA 600/M4-82-020 per 40 CFR 763 (NVLAP Lab #200346-0); Note: PLM is not consistently reliable in detecting asbestos in floor coverings and similar NOB materials. TEM is currently the only method that can be used to determine if this material can be considered or treated as non-asbestos-containing in New York State (also see EPA Advisory for floor tile, FR 59, 146, 38970, 8/1/94). NIST Accreditation requirements mandate that this report must not be reproduced except in full with the approval of the laboratory. This PLM report relates ONLY to the items tested.

Reviewed By: 



Please Reply To:

AmeriSci Los Angeles

24416 S. Main Street, Ste 308

Carson, California 90745

TEL: (310) 834-4868 • FAX: (310) 834-4772

FACSIMILE TELECOPY TRANSMISSION

To: Yesenia Galeana	From: Johana Perez
Executive Environmental Services Corporation	AmeriSci Job #: 920111297
Fax #:	Subject: PLM 1000 point count 3 day Result
	Client Project: 20-Z0046-0134; Building A
	(Admin / Room 3), Building B
	(Room 4), Building C (MP)
Email: info@execenv.com, ygaleana@execenv.com	

Date: Friday, November 20, 2020

Time: 13:52:28

Comments:

Number of Pages:

6
(including cover sheet)

CONFIDENTIALITY NOTICE: Unless otherwise indicated, the information contained in this communication is confidential information intended for use of the individual named above. If the reader of this communication is not the intended recipient, you are hereby notified that any dissemination, distribution or copying of this communication is prohibited. If you have received this communication in error, please immediately notify the sender by telephone and return the original message to the above address via the US Postal Service at our expense. Samples are disposed of in 60 days or unless otherwise instructed by the protocol or special instructions in writing. Thank you.

Certified Analysis Service 24 Hours A Day • 7 Days A Week Competitive Prices
visit our web site - www.amerisci.com

Boston • Los Angeles • New York • Richmond

**AmeriSci Los Angeles**

24416 S. Main Street, Ste 308

Carson, California 90745

TEL: (310) 834-4868 • FAX: (310) 834-4772

PLM Bulk Asbestos Report

Executive Environmental Services Corpo **Date Received** 11/17/20 **AmeriSci Job #** 920111297
Attn: Yesenia Galeana **Date Examined** 11/12/20 **P.O. #**
310 East Foothill Blvd. **Page** 1 **of** 2
Suite 200 **RE:** 20-Z0046-0134; Building A (Admin / Room 3), Building B
Arcadia, CA 91006 (Room 4), Building C (MPR), Building D (Rooms 10-12)

Client No. / HGA	Lab No.	Asbestos Present	Total % Asbestos
2011090134RK-11 Location: Exterior, South Wall / Exterior Stucco / T-O Exterior Walls Analyst Description: Beige/Grey, Heterogeneous, Non-Fibrous, Cementitious, Stucco Asbestos Types: Other Material: Non-Asbestos/Inert 56.6 %	920111297-01	No	NAD ¹ (by 1000 pt ct) by Johana Perez on 11/12/20
2011090134RK-12 Location: Exterior, West Wall - South End / Exterior Stucco Analyst Description: Beige/Grey, Heterogeneous, Non-Fibrous, Cementitious, Stucco Asbestos Types: Other Material: Non-Asbestos/Inert 50.9 %	920111297-02	No	NAD ¹ (by 1000 pt ct) by Johana Perez on 11/12/20
2011090134RK-13 Location: Exterior, West Wall - North End / Exterior Stucco Analyst Description: Beige/Grey, Heterogeneous, Non-Fibrous, Cementitious, Stucco Asbestos Types: Other Material: Non-Asbestos/Inert 41.6 %	920111297-03	No	NAD ¹ (by 1000 pt ct) by Johana Perez on 11/12/20
2011090134RK-14 Location: Exterior, East Wall / Exterior Stucco Analyst Description: Beige/Grey, Heterogeneous, Non-Fibrous, Cementitious, Stucco Asbestos Types: Chrysotile <0.1 % pc Other Material: Non-Asbestos/Inert 21.8 %	920111297-04	Yes	Trace (<0.1 % pc) ¹ (by 1000 pt ct) by Johana Perez on 11/12/20
2011090134RK-15 Location: Exterior, East Wall - North End / Exterior Stucco Analyst Description: Beige/Grey, Heterogeneous, Non-Fibrous, Cementitious, Stucco Asbestos Types: Chrysotile <0.1 % pc Other Material: Non-Asbestos/Inert 46.1 %	920111297-05	Yes	Trace (<0.1 % pc) ¹ (by 1000 pt ct) by Johana Perez on 11/12/20

Client Name: Executive Environmental Services Corporation

PLM Bulk Asbestos Report20-Z0046-0134; Building A (Admin / Room 3), Building B
(Room 4), Building C (MPR), Building D (Rooms 10-12)

Client No. / HGA	Lab No.	Asbestos Present	Total % Asbestos
2011090134RK-16	920111297-06	Yes	Trace (<0.1 % pc) ¹ (by 1000 pt ct) by Johana Perez on 11/12/20
Location: Exterior, North Wall / Exterior Stucco Analyst Description: Beige/Grey, Heterogeneous, Non-Fibrous, Cementitious, Stucco Asbestos Types: Chrysotile <0.1 % pc Other Material: Non-Asbestos/Inert 33.9 %			
2011090134RK-17	920111297-07	Yes	Trace (<0.1 % pc) ¹ (by 1000 pt ct) by Johana Perez on 11/12/20
Location: Exterior, East Wall Above Covered Walkway 2 / Exterior Stucco Analyst Description: Beige/Grey, Heterogeneous, Non-Fibrous, Cementitious, Stucco Asbestos Types: Chrysotile <0.1 % pc Other Material: Non-Asbestos/Inert 46.6 %			

Reporting Notes:

(1) EPA 1000 Point Count Analysis performed on inert residue remaining after 480C heat and HCl acid treatments.

Analyzed By: Johana Perez ; Date Analyzed: 11/12/2020 11.20.20

*NAD = no asbestos detected; Detection Limit <1%; Reporting Limits: CVES = 1%, 400 Pt Ct = 0.25%, 1000 Pt Ct = 0.1%; NA = not analyzed; NA/PS = not analyzed / positive stop; NVA = No Visible Asbestos; PLM (polarized light microscopy) Bulk Asbestos Analysis by EPA 600/R-93/116, including requirements for EPA 600/M4-82-020 per 40 CFR 763 (NVLAP Lab #200346-0); Note: PLM is not consistently reliable in detecting asbestos in floor coverings and similar NOB materials. TEM is currently the only method that can be used to determine if this material can be considered or treated as non-asbestos-containing in New York State (also see EPA Advisory for floor tile, FR 59, 146, 38970, 8/1/94). NIST Accreditation requirements mandate that this report must not be reproduced except in full with the approval of the laboratory. This PLM report relates ONLY to the items tested.

Reviewed By: 

Industrial Hygiene Laboratory Submittal
Asbestos --- PLM

<input checked="" type="checkbox"/>	Originating Office 310 E. Foothill Blvd., Suite 200 Arcadia, CA 91006 Phone: 626.441.7050 Fax: 626.441.0016	<input checked="" type="checkbox"/> AmeriSci <input type="checkbox"/> EMLab (Glendale) <input type="checkbox"/> LA Testing	Lab Submitted to:
-------------------------------------	--	--	--------------------------

☐ Routine
 ☐ RUSH (surcharges may apply)

(5 Working Days)

Circle 6 hours

24 hours

48 hours

3 to 5 days

Project #:
20-Z0046-0134

Sampled by:
Tim Galea

Site Zip Code:	Sample Date:
91770	11/09/2020

The receiving Laboratory is required to complete the following:

1. All invoices are to be sent to: 310 E. Foothill Blvd., Suite 200, Arcadia, CA 91006 with a copy of the lab report.
2. Analyze all samples by PLM by EPA 600/R-93/116.
3. Stop analysis of homogeneous groups at first positive that is greater than or equal to 1.0%

Building Name: Building A (Admin / Room 3)

4. All lab reports and invoices are to contain the Project Number from above.
5. Unsigned and reports marked draft are unacceptable.
6. Report to the attention of: Yesenia Galeana, Phone: (562) 889-1327

3. ☒ **Optional items to be completed by the laboratory (if check marked):** -

Email Report to: ☒ Info@execenv.com

☒ Other: vgaleana@execenv.com;

<input checked="" type="checkbox"/>	US Mail Report to:	<input checked="" type="checkbox"/>	Originating office check marked above
-------------------------------------	--------------------	-------------------------------------	---------------------------------------

Other: ☐

☐ Alternate billing address:

Sample No.:	Sample Location - Include Room information where appropriate	Material Description	Homogeneous Location	No.	Quantity	Percent Damaged
-01	Exterior, West Wall	Exterior stucco	T-0 exterior walls	1	4,500sf	< 1
-02	Exterior, south wall					
-03	Exterior, east wall					
-04	Exterior, east wall at breezeway					
-05	Exterior, north wall					

Notes:

02/12/2020 12:15 PM

Received
By Date,
& Time:

11/10/2021 12:15

Released
By: Date:
& Time:



Industrial Hygiene Laboratory Submittal
Asbestos -- PLM

<input checked="" type="checkbox"/>	Originating Office 310 E. Foothill Blvd., Suite 200 Arcadia, CA 91006 Phone: 626.441.7050 Fax: 626.441.0016	Lab Submitted to: <input checked="" type="checkbox"/> AmeriSci <input type="checkbox"/> EMLab (Glendale) <input type="checkbox"/> LA Testing
-------------------------------------	--	--

Lab Submitted to:

☒ AmeriSci

☐ EMLab (Glendale)

☐ LA Testing

<input type="checkbox"/> Routine	(5 Working Days)
<input type="checkbox"/> RUSH (surcharges may apply)	Circle One
	6 hours 24 hours 48 hours 72 hours 96 hours 120 hours 144 hours 168 hours 192 hours 216 hours 240 hours 264 hours 288 hours 312 hours 336 hours 360 hours 384 hours 408 hours 432 hours 456 hours 480 hours 504 hours 528 hours 552 hours 576 hours 600 hours 624 hours 648 hours 672 hours 696 hours 720 hours 744 hours 768 hours 792 hours 816 hours 840 hours 864 hours 888 hours 912 hours 936 hours 960 hours 984 hours 1008 hours 1032 hours 1056 hours 1080 hours 1104 hours 1128 hours 1152 hours 1176 hours 1200 hours 1224 hours 1248 hours 1272 hours 1296 hours 1320 hours 1344 hours 1368 hours 1392 hours 1416 hours 1440 hours 1464 hours 1488 hours 1512 hours 1536 hours 1560 hours 1584 hours 1608 hours 1632 hours 1656 hours 1680 hours 1704 hours 1728 hours 1752 hours 1776 hours 1800 hours 1824 hours 1848 hours 1872 hours 1896 hours 1920 hours 1944 hours 1968 hours 1992 hours 2016 hours 2040 hours 2064 hours 2088 hours 2112 hours 2136 hours 2160 hours 2184 hours 2208 hours 2232 hours 2256 hours 2280 hours 2304 hours 2328 hours 2352 hours 2376 hours 2400 hours 2424 hours 2448 hours 2472 hours 2496 hours 2520 hours 2544 hours 2568 hours 2592 hours 2616 hours 2640 hours 2664 hours 2688 hours 2712 hours 2736 hours 2760 hours 2784 hours 2808 hours 2832 hours 2856 hours 2880 hours 2904 hours 2928 hours 2952 hours 2976 hours 3000 hours 3024 hours 3048 hours 3072 hours 3096 hours 3120 hours 3144 hours 3168 hours 3192 hours 3216 hours 3240 hours 3264 hours 3288 hours 3312 hours 3336 hours 3360 hours 3384 hours 3408 hours 3432 hours 3456 hours 3480 hours 3504 hours 3528 hours 3552 hours 3576 hours 3600 hours 3624 hours 3648 hours 3672 hours 3696 hours 3720 hours 3744 hours 3768 hours 3792 hours 3816 hours 3840 hours 3864 hours 3888 hours 3912 hours 3936 hours 3960 hours 3984 hours 4008 hours 4032 hours 4056 hours 4080 hours 4104 hours 4128 hours 4152 hours 4176 hours 4200 hours 4224 hours 4248 hours 4272 hours 4296 hours 4320 hours 4344 hours 4368 hours 4392 hours 4416 hours 4440 hours 4464 hours 4488 hours 4512 hours 4536 hours 4560 hours 4584 hours 4608 hours 4632 hours 4656 hours 4680 hours 4704 hours 4728 hours 4752 hours 4776 hours 4800 hours 4824 hours 4848 hours 4872 hours 4896 hours 4920 hours 4944 hours 4968 hours 4992 hours 5016 hours 5040 hours 5064 hours 5088 hours 5112 hours 5136 hours 5160 hours 5184 hours 5208 hours 5232 hours 5256 hours 5280 hours 5304 hours 5328 hours 5352 hours 5376 hours 5400 hours 5424 hours 5448 hours 5472 hours 5496 hours 5520 hours 5544 hours 5568 hours 5592 hours 5616 hours 5640 hours 5664 hours 5688 hours 5712 hours 5736 hours 5760 hours 5784 hours 5808 hours 5832 hours 5856 hours 5880 hours 5904 hours 5928 hours 5952 hours 5976 hours 6000 hours 6024 hours 6048 hours 6072 hours 6096 hours 6120 hours 6144 hours 6168 hours 6192 hours 6216 hours 6240 hours 6264 hours 6288 hours 6312 hours 6336 hours 6360 hours 6384 hours 6408 hours 6432 hours 6456 hours 6480 hours 6504 hours 6528 hours 6552 hours 6576 hours 6600 hours 6624 hours 6648 hours 6672 hours 6696 hours 6720 hours 6744 hours 6768 hours 6792 hours 6816 hours 6840 hours 6864 hours 6888 hours 6912 hours 6936 hours 6960 hours 6984 hours 7008 hours 7032 hours 7056 hours 7080 hours 7104 hours 7128 hours 7152 hours 7176 hours 7200 hours 7224 hours 7248 hours 7272 hours 7296 hours 7320 hours 7344 hours 7368 hours 7392 hours 7416 hours 7440 hours 7464 hours 7488 hours 7512 hours 7536 hours 7560 hours 7584 hours 7608 hours 7632 hours 7656 hours 7680 hours 7704 hours 7728 hours 7752 hours 7776 hours 7800 hours 7824 hours 7848 hours 7872 hours 7896 hours 7920 hours 7944 hours 7968 hours 7992 hours 8016 hours 8040 hours 8064 hours 8088 hours 8112 hours 8136 hours 8160 hours 8184 hours 8208 hours 8232 hours 8256 hours 8280 hours 8304 hours 8328 hours 8352 hours 8376 hours 8400 hours 8424 hours 8448 hours 8472 hours 8496 hours 8520 hours 8544 hours 8568 hours 8592 hours 8616 hours 8640 hours 8664 hours 8688 hours 8712 hours 8736 hours 8760 hours 8784 hours 8808 hours 8832 hours 8856 hours 8880 hours 8904 hours 8928 hours 8952 hours 8976 hours 9000 hours 9024 hours 9048 hours 9072 hours 9096 hours 9120 hours 9144 hours 9168 hours 9192 hours 9216 hours 9240 hours 9264 hours 9288 hours 9312 hours 9336 hours 9360 hours 9384 hours 9408 hours 9432 hours 9456 hours 9480 hours 9504 hours 9528 hours 9552 hours 9576 hours 9600 hours 9624 hours 9648 hours 9672 hours 9696 hours 9720 hours 9744 hours 9768 hours 9792 hours 9816 hours 9840 hours 9864 hours 9888 hours 9912 hours 9936 hours 9960 hours 9984 hours 10000 hours

Project #:
20-Z0046-0134

Sampled by:
Tim Galeana/Rhys Kuzmic

Site Zip Code: 91770	Sample Date: 11/09/2020
-------------------------	----------------------------

Building Name: Buildings (B-2004)

The receiving Laboratory is required to complete the following:

- The receiving Laboratory is required to complete the following:**
1. All invoices are to be sent to: 310 E. Foothill Blvd., Suite 200, Arcadia, CA 91006 with a copy of the lab report.
 2. Analyze all samples by PLM by EPA 600/R-93/116.
 3. Stop analysis of homogeneous groups at first positive that is greater than or equal to 1.0%
 4. All lab reports and invoices are to contain the Project Number from above.
 5. Unsigned and reports marked draft are unacceptable.
 6. Report to the attention of: Yesenia Galeana, Phone: (562) 889-1327

Other: ☒ Info@execenv.com; ☒ ygaleana@execenv.com;

☒ U.S. Mail. Remit to: ☒ Originating office check marked above ☐ Other: ☐ Alternate billing address: ☐

Sample No.:	Sample Location - Include Room information where appropriate	Material Description	Homogeneous Location	No.	Quantity	Percent Damaged
-06	Exterior, Brezenway cells SW	Exterior stucco	To exterior walls and breezenway	2	2,700 SF	< 1
-07	Exterior, south wall					
-08	Exterior, west wall					
-09	Exterior, north wall					
-10	Exterior, east wall					

Prefix: 2011090134R5

Notes: [REDACTED] & Time: [REDACTED]
Released By: Date: [REDACTED]
Rev. 1/19

Plus V₂ - 1/10/2023 13:15 PM

11/10/2006 12:15

92011158



Industrial Hygiene Laboratory Submittal
Asbestos -- PLM

Originating Office
☒ 310 E. Foothill Blvd., Suite 200
Arcadia, CA 91006
Phone: 626.441.7050
Fax: 626.441.0016

Lab Submitted to:
☒ AmeriSci
☐ EMLab (Glendale)
☐ LA Testing

☐ Routine (5 Days)
☒ RUSH (surcharges may apply)
Circle 6 24 48 3 to 5
One hours hours days

Project #: 20-Z0046-0134
Sampled by: Tim Galeana/Rhys Kuzmic
Site Zip Code: 91770
Sample Date: 11/09/2020
Page 3 of 4

The receiving Laboratory is required to complete the following:

1. All invoices are to be sent to: 310 E. Foothill Blvd., Suite 200, Arcadia, CA 91006 with a copy of the lab report.
2. Analyze all samples by PLM by EPA 600/R-93/116.
3. Stop analysis of homogeneous groups at first positive that is greater than or equal to 1.0%

Building Name: Building C (MPR)

Optional Items to be completed by the laboratory (if check marked): ☒ Email Report to: info@execenv.com ☒ Other: ygaleana@execenv.com

☒ US Mail Report to: ☒ Originating office check marked above ☐ Other: ☐ Alternate billing address:

Sample No.:	Sample Location - Include Room information where appropriate	Material Description	Homogeneous Location	No.	Quantity	Percent Damaged
-11	Exterior, south wall	Exterior stucco	FO exterior walls	3	6,400 SF	< 1
-12	Exterior, West Wall-south end					
-13	Exterior, West Wall-north end					
-14	Exterior, east wall					
-15	Exterior, east wall-north end					
-16	Exterior, North wall					
-17	Exterior, east wall above covered walkway 2					

Prefix: 2011090134RCK

Notes:

Released By, Date:	Received By, Date:
11/10/2020 12:15 PM	11/10/2020 12:15
By, Date:	
11/10/2020 12:15	

92011158



Industrial Hygiene Laboratory Submittal Asbestos -- PLM

Originating Office
☒ 310 E. Foothill Blvd., Suite 200
 Arcadia, CA 91006
 Phone: 626.441.7050
 Fax: 626.441.0016

Lab Submitted to:
☒ AmeriSci
☐ EMLab (Glendale)
☐ LA Testing

<input type="checkbox"/> Routine (5 Days) Circle 6 hours	<input type="checkbox"/> Rush (surcharges may apply) 24 hours	<input type="checkbox"/> 3 to 5 days	Project #: 20-Z0046-0134	Sampled by: Tim Galeana/Rhys Kuzmic	Site Zip Code: 91770	Sample Date: 11/09/2020	Page 4 of 4
---	---	--------------------------------------	------------------------------------	---	--------------------------------	-----------------------------------	--------------------

Building Name: Bldg 10 (Rm 10-12)

The receiving Laboratory is required to complete the following:

- All invoices are to be sent to: 310 E. Foothill Blvd., Suite 200, Arcadia, CA 91006 with a copy of the lab report.
- Analyze all samples by PLM by EPA 600/R-93/116.
- Stop analysis of homogeneous groups at first positive that is greater than or equal to 1.0%

Optional Items to be completed by the laboratory (if check marked): ☒ Email Report to: Info@execenv.com ☒ Other: ygaleana@execenv.com

☒ US Mail Report to: ☒ Originating office check marked above ☐ Other: ☐ Alternate billing address:

Sample No.:	Sample Location - Include Room information where appropriate	Material Description	Homogeneous Location	No.	Quantity	Percent Damaged
-18	Exterior, west wall	Exterior stucco	T-0 exterior walls	4	3,000 SF	<1
-19	Exterior, north wall - west end					
-20	Exterior, south wall					
-21	Exterior, east wall					
-22	Exterior, north wall - east end					

Prefix: 201190134R

Notes:

By Date: <u>11/10/2020</u>	Received By Date: <u>11/10/2020</u>	Released By Date: <u>11/10/2020</u>	By Date: <u>11/10/2020</u>
----------------------------	-------------------------------------	-------------------------------------	----------------------------

Rev. 1/19 ©Copyright 2019 All Rights Reserved Form: AL-006PLM



Please Reply To:

AmeriSci Los Angeles

24416 S. Main Street, Ste 308

Carson, California 90745

TEL: (310) 834-4868 • FAX: (310) 834-4772

FACSIMILE TELECOPY TRANSMISSION

To: Yesenia Galeana	From: Johana Perez
Executive Environmental Services Corporation	AmeriSci Job #: 920111262
Fax #:	Subject: PLM 5 day Results
	Client Project: 20-Z0046-0134; Building D (Room 13-16), Building E (Room 17-19), Building F (Ro
Email: info@execenv.com, ygaleana@execenv.com	

Date: Wednesday, November 18, 2020

Time: 09:55:45

Comments:

Number of Pages: 23
(including cover sheet)

CONFIDENTIALITY NOTICE: Unless otherwise indicated, the information contained in this communication is confidential information intended for use of the individual named above. If the reader of this communication is not the intended recipient, you are hereby notified that any dissemination, distribution or copying of this communication is prohibited. If you have received this communication in error, please immediately notify the sender by telephone and return the original message to the above address via the US Postal Service at our expense. Samples are disposed of in 60 days or unless otherwise instructed by the protocol or special instructions in writing. Thank you.

Certified Analysis Service 24 Hours A Day • 7 Days A Week Competitive Prices
visit our web site - www.amerisci.com

Boston • Los Angeles • New York • Richmond

**AmeriSci Los Angeles**

24416 S. Main Street, Ste 308

Carson, California 90745

TEL: (310) 834-4868 • FAX: (310) 834-4772

PLM Bulk Asbestos Report

Executive Environmental Services Corpo **Date Received** 11/13/20 **AmeriSci Job #** 920111262
Attn: Yesenia Galeana **Date Examined** 11/17/20 **P.O. #**
310 East Foothill Blvd. **Page** 1 **of** 11
Suite 200
Arcadia, CA 91006
RE: 20-Z0046-0134; Building D (Room 13-16), Building E (Room 17-19), Building F (Rooms 20-23), Building H (Rooms 5-9), Restroom Building 1, Restroom Building 2, Covered Walkways, Campus

Client No. / HGA	Lab No.	Asbestos Present	Total % Asbestos
2011120134RK-23 Location: Exterior, South Wall / Exterior Stucco / T-O Exterior Walls And West Breezeway Analyst Description: White/Grey, Homogeneous, Non-Fibrous, Cementitious, Stucco Asbestos Types: Other Material: Non-fibrous 100 %	920111262-01	No	NAD (by CVES) by Johana Perez on 11/17/20
2011120134RK-24 Location: Exterior, East Wall / Exterior Stucco Analyst Description: White/Grey, Homogeneous, Non-Fibrous, Cementitious, Stucco Asbestos Types: Other Material: Non-fibrous 100 %	920111262-02	No	NAD (by CVES) by Johana Perez on 11/17/20
2011120134RK-25 Location: Exterior, North Wall / Exterior Stucco Analyst Description: White/Grey, Homogeneous, Non-Fibrous, Cementitious, Stucco Asbestos Types: Other Material: Non-fibrous 100 %	920111262-03	No	NAD (by CVES) by Johana Perez on 11/17/20
2011120134RK-26 Location: Exterior, West Wall / Exterior Stucco Analyst Description: White/Grey, Homogeneous, Non-Fibrous, Cementitious, Stucco Asbestos Types: Other Material: Non-fibrous 100 %	920111262-04	No	NAD (by CVES) by Johana Perez on 11/17/20
2011120134RK-27 Location: Exterior, West Breezeway Ceiling - SE / Exterior Stucco Analyst Description: White/Grey, Homogeneous, Non-Fibrous, Cementitious, Stucco Asbestos Types: Other Material: Non-fibrous 100 %	920111262-05	No	NAD (by CVES) by Johana Perez on 11/17/20

Client Name: Executive Environmental Services Corporation

PLM Bulk Asbestos Report

20-Z0046-0134; Building D (Room 13-16), Building E (Room 17-19), Building F (Rooms 20-23), Building H (Rooms 5-9), Restroom Building 1, Restroom Building 2, Covered Walkways, Campus

Client No. / HGA	Lab No.	Asbestos Present	Total % Asbestos
2011120134RK-28	920111262-06	No	NAD
Location: Exterior, North Wall - West End / Exterior Stucco / T-O Exterior Walls			(by CVES) by Johana Perez on 11/17/20
Analyst Description: White/Grey, Homogeneous, Non-Fibrous, Cementitious, Stucco			
Asbestos Types:			
Other Material: Non-fibrous 100 %			
2011120134RK-29	920111262-07	No	NAD
Location: Exterior, West Wall / Exterior Stucco			(by CVES) by Johana Perez on 11/17/20
Analyst Description: White/Grey, Homogeneous, Non-Fibrous, Cementitious, Stucco			
Asbestos Types:			
Other Material: Non-fibrous 100 %			
2011120134RK-30	920111262-08	No	NAD
Location: Exterior, South Wall / Exterior Stucco			(by CVES) by Johana Perez on 11/17/20
Analyst Description: White/Grey, Homogeneous, Non-Fibrous, Cementitious, Stucco			
Asbestos Types:			
Other Material: Non-fibrous 100 %			
2011120134RK-31	920111262-09	No	NAD
Location: Exterior, East Wall / Exterior Stucco			(by CVES) by Johana Perez on 11/17/20
Analyst Description: White/Grey, Homogeneous, Non-Fibrous, Cementitious, Stucco			
Asbestos Types:			
Other Material: Non-fibrous 100 %			
2011120134RK-32	920111262-10	No	NAD
Location: Exterior, North Wall - East End / Exterior Stucco			(by CVES) by Johana Perez on 11/17/20
Analyst Description: White/Grey, Homogeneous, Non-Fibrous, Cementitious, Stucco			
Asbestos Types:			
Other Material: Non-fibrous 100 %			
2011120134RK-33	920111262-11	No	NAD
Location: Exterior, South Wall / Exterior Stucco / T-O Exterior Walls And West Breezeway			(by CVES) by Johana Perez on 11/17/20
Analyst Description: White/Grey, Homogeneous, Non-Fibrous, Cementitious, Stucco			
Asbestos Types:			
Other Material: Non-fibrous 100 %			

Client Name: Executive Environmental Services Corporation

PLM Bulk Asbestos Report

20-Z0046-0134; Building D (Room 13-16), Building E (Room 17-19), Building F (Rooms 20-23), Building H (Rooms 5-9), Restroom Building 1, Restroom Building 2, Covered Walkways, Campus

Client No. / HGA	Lab No.	Asbestos Present	Total % Asbestos
2011120134RK-34	920111262-12	No	NAD
Location: Exterior, East Wall / Exterior Stucco			(by CVES) by Johana Perez on 11/17/20
Analyst Description: White/Grey, Homogeneous, Non-Fibrous, Cementitious, Stucco			
Asbestos Types:			
Other Material: Non-fibrous 100 %			
2011120134RK-35	920111262-13	No	NAD
Location: Exterior, North Wall / Exterior Stucco			(by CVES) by Johana Perez on 11/17/20
Analyst Description: White/Grey, Homogeneous, Non-Fibrous, Cementitious, Stucco			
Asbestos Types:			
Other Material: Non-fibrous 100 %			
2011120134RK-36	920111262-14	No	NAD
Location: Exterior, West Wall / Exterior Stucco			(by CVES) by Johana Perez on 11/17/20
Analyst Description: White/Grey, Homogeneous, Non-Fibrous, Cementitious, Stucco			
Asbestos Types:			
Other Material: Non-fibrous 100 %			
2011120134RK-37	920111262-15	No	NAD
Location: Exterior, West Breezeway Ceiling - SE / Exterior Stucco			(by CVES) by Johana Perez on 11/17/20
Analyst Description: White/Grey, Homogeneous, Non-Fibrous, Cementitious, Stucco			
Asbestos Types:			
Other Material: Non-fibrous 100 %			
2011120134RK-38	920111262-16	No	NAD
Location: Exterior, South Wall / Exterior Stucco / T-O Exterior Walls (Select Walls Some Are Cinderblock) And Overhang			(by CVES) by Johana Perez on 11/17/20
Analyst Description: Grey, Homogeneous, Non-Fibrous, Cementitious, Stucco			
Asbestos Types:			
Other Material: Non-fibrous 100 %			
2011120134RK-39	920111262-17	No	NAD
Location: Exterior, West Wall / Exterior Stucco			(by CVES) by Johana Perez on 11/17/20
Analyst Description: Grey, Homogeneous, Non-Fibrous, Cementitious, Stucco			
Asbestos Types:			
Other Material: Non-fibrous 100 %			

Client Name: Executive Environmental Services Corporation

PLM Bulk Asbestos Report

20-Z0046-0134; Building D (Room 13-16), Building E (Room 17-19), Building F (Rooms 20-23), Building H (Rooms 5-9), Restroom Building 1, Restroom Building 2, Covered Walkways, Campus

Client No. / HGA	Lab No.	Asbestos Present	Total % Asbestos
2011120134RK-40 Location: Exterior, North Wall / Exterior Stucco Analyst Description: Grey, Homogeneous, Non-Fibrous, Cementitious, Stucco Asbestos Types: Chrysotile <1. % Other Material: Non-fibrous 100 %	920111262-18	Yes	Trace (<1 %) (by CVES) by Johana Perez on 11/17/20
2011120134RK-41 Location: Exterior, East Wall / Exterior Stucco Analyst Description: Grey, Homogeneous, Non-Fibrous, Cementitious, Stucco Asbestos Types: Chrysotile <1. % Other Material: Non-fibrous 100 %	920111262-19	Yes	Trace (<1 %) (by CVES) by Johana Perez on 11/17/20
2011120134RK-42 Location: Exterior, Overhang - SE / Exterior Stucco Analyst Description: Grey, Homogeneous, Non-Fibrous, Cementitious, Stucco Asbestos Types: Chrysotile <1. % Other Material: Non-fibrous 100 %	920111262-20	Yes	Trace (<1 %) (by CVES) by Johana Perez on 11/17/20
2011120134RK-43 Location: Exterior, South Wall / Exterior Stucco / T-O Exterior Walls And West Breezeway Analyst Description: Grey, Homogeneous, Non-Fibrous, Cementitious, Stucco Asbestos Types: Other Material: Non-fibrous 100 %	920111262-21	No	NAD (by CVES) by Johana Perez on 11/17/20
2011120134RK-44 Location: Exterior, North Wall / Exterior Stucco Analyst Description: Grey, Homogeneous, Non-Fibrous, Cementitious, Stucco Asbestos Types: Other Material: Non-fibrous 100 %	920111262-22	No	NAD (by CVES) by Johana Perez on 11/17/20
2011120134RK-45 Location: Exterior, West Wall / Exterior Stucco Analyst Description: Grey, Homogeneous, Non-Fibrous, Cementitious, Stucco Asbestos Types: Other Material: Non-fibrous 100 %	920111262-23	No	NAD (by CVES) by Johana Perez on 11/17/20

Client Name: Executive Environmental Services Corporation

PLM Bulk Asbestos Report

20-Z0046-0134; Building D (Room 13-16), Building E (Room 17-19), Building F (Rooms 20-23), Building H (Rooms 5-9), Restroom Building 1, Restroom Building 2, Covered Walkways, Campus

Client No. / HGA	Lab No.	Asbestos Present	Total % Asbestos
2011120134RK-46	920111262-24	No	NAD
Location: Exterior, East Wall / Exterior Stucco			(by CVES) by Johana Perez on 11/17/20
Analyst Description: Grey, Heterogeneous, Non-Fibrous, Cementitious, Stucco Asbestos Types: Other Material: Non-fibrous 100 %			
2011120134RK-47	920111262-25	No	NAD
Location: Exterior, West Breezeway Ceiling - SE / Exterior Stucco			(by CVES) by Johana Perez on 11/17/20
Analyst Description: Grey, Homogeneous, Non-Fibrous, Cementitious, Stucco Asbestos Types: Other Material: Non-fibrous 100 %			
2011120134RK-48	920111262-26	No	NAD
Location: Exterior, North Wall / Exterior Stucco / T-O Exterior Walls And West Breezeway			(by CVES) by Johana Perez on 11/17/20
Analyst Description: Grey, Homogeneous, Non-Fibrous, Cementitious, Stucco Asbestos Types: Other Material: Non-fibrous 100 %			
2011120134RK-49	920111262-27	No	NAD
Location: Exterior, South Wall / Exterior Stucco			(by CVES) by Johana Perez on 11/17/20
Analyst Description: Grey, Homogeneous, Non-Fibrous, Cementitious, Stucco Asbestos Types: Other Material: Non-fibrous 100 %			
2011120134RK-50	920111262-28	No	NAD
Location: Exterior, East Wall / Exterior Stucco			(by CVES) by Johana Perez on 11/17/20
Analyst Description: Grey, Homogeneous, Non-Fibrous, Cementitious, Stucco Asbestos Types: Other Material: Non-fibrous 100 %			
2011120134RK-51	920111262-29	No	NAD
Location: Exterior, West Wall / Exterior Stucco			(by CVES) by Johana Perez on 11/17/20
Analyst Description: Grey, Homogeneous, Non-Fibrous, Cementitious, Stucco Asbestos Types: Other Material: Non-fibrous 100 %			

Client Name: Executive Environmental Services Corporation

PLM Bulk Asbestos Report

20-Z0046-0134; Building D (Room 13-16), Building E (Room 17-19), Building F (Rooms 20-23), Building H (Rooms 5-9), Restroom Building 1, Restroom Building 2, Covered Walkways, Campus

Client No. / HGA	Lab No.	Asbestos Present	Total % Asbestos
2011120134RK-52	920111262-30	No	NAD
Location: Exterior, West Breezeway Ceiling - SE / Exterior Stucco			(by CVES) by Johana Perez on 11/17/20
Analyst Description: Grey, Homogeneous, Non-Fibrous, Cementitious, Stucco			
Asbestos Types:			
Other Material: Non-fibrous 100 %			
2011120134RK-53	920111262-31	No	NAD
Location: Covered Walkway 7 Exterior, East Wall North Side / Exterior Stucco / Covered Walkway 7 Walls			(by CVES) by Johana Perez on 11/17/20
Analyst Description: Grey, Homogeneous, Non-Fibrous, Cementitious, Stucco			
Asbestos Types:			
Other Material: Non-fibrous 100 %			
2011120134RK-54	920111262-32	No	NAD
Location: Covered Walkway 7 Exterior, South Side Wall / Exterior Stucco			(by CVES) by Johana Perez on 11/17/20
Analyst Description: Grey, Homogeneous, Non-Fibrous, Cementitious, Stucco			
Asbestos Types:			
Other Material: Non-fibrous 100 %			
2011120134RK-55	920111262-33	No	NAD
Location: Covered Walkway 7 Exterior, West Wall South Side / Exterior Stucco			(by CVES) by Johana Perez on 11/17/20
Analyst Description: Grey, Homogeneous, Non-Fibrous, Cementitious, Stucco			
Asbestos Types:			
Other Material: Non-fibrous 100 %			
2011120134RK-56	920111262-34	No	NAD
Location: Covered Walkway 10 Exterior, East Wall East Side / Exterior Stucco / Covered Walkway 10 Walls			(by CVES) by Johana Perez on 11/17/20
Analyst Description: Grey, Homogeneous, Non-Fibrous, Cementitious, Stucco			
Asbestos Types:			
Other Material: Non-fibrous 100 %			
2011120134RK-57	920111262-35	No	NAD
Location: Covered Walkway 10 Exterior, East Wall South Side / Exterior Stucco			(by CVES) by Johana Perez on 11/17/20
Analyst Description: Grey, Homogeneous, Non-Fibrous, Cementitious, Stucco			
Asbestos Types:			
Other Material: Non-fibrous 100 %			

Client Name: Executive Environmental Services Corporation

PLM Bulk Asbestos Report

20-Z0046-0134; Building D (Room 13-16), Building E (Room 17-19), Building F (Rooms 20-23), Building H (Rooms 5-9), Restroom Building 1, Restroom Building 2, Covered Walkways, Campus

Client No. / HGA	Lab No.	Asbestos Present	Total % Asbestos
2011120134RK-58	920111262-36	No	NAD
Location: Covered Walkway 10 Exterior, West Wall North Side / Exterior Stucco			(by CVES) by Johana Perez on 11/17/20
Analyst Description: Grey, Homogeneous, Non-Fibrous, Cementitious, Stucco			
Asbestos Types:			
Other Material: Non-fibrous 100 %			
2011120134RK-59	920111262-37	No	NAD
Location: Kindergarten Playground, SE / Asphalt Paving / Kindergarten Playground			(by CVES) by Johana Perez on 11/18/20
Analyst Description: Black, Homogeneous, Non-Fibrous, Asphalt			
Asbestos Types:			
Other Material: Cellulose 3 %, Non-fibrous 97 %			
2011120134RK-60	920111262-38	No	NAD
Location: Kindergarten Playground, SW / Asphalt Paving			(by CVES) by Johana Perez on 11/18/20
Analyst Description: Black, Homogeneous, Non-Fibrous, Asphalt			
Asbestos Types:			
Other Material: Cellulose 3 %, Non-fibrous 97 %			
2011120134RK-61	920111262-39	No	NAD
Location: Kindergarten Playground, North / Asphalt Paving			(by CVES) by Johana Perez on 11/18/20
Analyst Description: Black, Homogeneous, Non-Fibrous, Asphalt			
Asbestos Types:			
Other Material: Cellulose 3 %, Non-fibrous 97 %			
2011120134RK-62	920111262-40	No	NAD
Location: South Playground, SE / Asphalt Paving / South Playground			(by CVES) by Johana Perez on 11/18/20
Analyst Description: Black, Homogeneous, Non-Fibrous, Asphalt			
Asbestos Types:			
Other Material: Cellulose 3 %, Non-fibrous 97 %			
2011120134RK-63	920111262-41	No	NAD
Location: South Playground, West Of Portable 25 / Asphalt Paving			(by CVES) by Johana Perez on 11/18/20
Analyst Description: Black, Homogeneous, Non-Fibrous, Asphalt			
Asbestos Types:			
Other Material: Cellulose 3 %, Non-fibrous 97 %			

Client Name: Executive Environmental Services Corporation

PLM Bulk Asbestos Report

20-Z0046-0134; Building D (Room 13-16), Building E (Room 17-19), Building F (Rooms 20-23), Building H (Rooms 5-9), Restroom Building 1, Restroom Building 2, Covered Walkways, Campus

Client No. / HGA	Lab No.	Asbestos Present	Total % Asbestos
2011120134RK-64	920111262-42	No	NAD
Location: South Playground, Near Center / Asphalt Paving			(by CVES) by Johana Perez on 11/18/20
Analyst Description: Black, Homogeneous, Non-Fibrous, Asphalt			
Asbestos Types:			
Other Material: Cellulose 3 %, Non-fibrous 97 %			
2011120134RK-65	920111262-43	No	NAD
Location: South Playground, SW / Asphalt Paving			(by CVES) by Johana Perez on 11/18/20
Analyst Description: Black, Homogeneous, Non-Fibrous, Asphalt			
Asbestos Types:			
Other Material: Cellulose 3 %, Non-fibrous 97 %			
2011120134RK-66	920111262-44	No	NAD
Location: South Playground, NW / Asphalt Paving			(by CVES) by Johana Perez on 11/18/20
Analyst Description: Black, Homogeneous, Non-Fibrous, Asphalt			
Asbestos Types:			
Other Material: Cellulose 3 %, Non-fibrous 97 %			
2011120134RK-67	920111262-45	No	NAD
Location: Driveway To South Parking Lot, NE / Asphalt Paving / Driveway To South Parking Lot			(by CVES) by Johana Perez on 11/18/20
Analyst Description: Black, Homogeneous, Non-Fibrous, Asphalt			
Asbestos Types:			
Other Material: Cellulose 3 %, Non-fibrous 97 %			
2011120134RK-68	920111262-46	No	NAD
Location: Driveway To South Parking Lot, Near Center / Asphalt Paving			(by CVES) by Johana Perez on 11/18/20
Analyst Description: Black, Homogeneous, Non-Fibrous, Asphalt			
Asbestos Types:			
Other Material: Cellulose 3 %, Non-fibrous 97 %			
2011120134RK-69	920111262-47	No	NAD
Location: Driveway To South Parking Lot, South / Asphalt Paving			(by CVES) by Johana Perez on 11/18/20
Analyst Description: Black, Homogeneous, Non-Fibrous, Asphalt			
Asbestos Types:			
Other Material: Cellulose 3 %, Non-fibrous 97 %			

Client Name: Executive Environmental Services Corporation

PLM Bulk Asbestos Report

20-Z0046-0134; Building D (Room 13-16), Building E (Room 17-19), Building F (Rooms 20-23), Building H (Rooms 5-9), Restroom Building 1, Restroom Building 2, Covered Walkways, Campus

Client No. / HGA	Lab No.	Asbestos Present	Total % Asbestos
2011120134RK-70	920111262-48	No	NAD
Location: School Sign At South Parking Lot, On Support Post / Texture Coat On Metal / School Sign At South Parking Lot			(by CVES) by Johana Perez on 11/18/20
Analyst Description: Black, Homogeneous, Non-Fibrous, Asphalt Asbestos Types: Other Material: Cellulose 3 %, Non-fibrous 97 %			
2011120134RK-71	920111262-49	No	NAD
Location: School Sign At South Parking Lot, On Support Post / Texture Coat On Metal			(by CVES) by Johana Perez on 11/18/20
Analyst Description: Off-White\Red, Homogeneous, Non-Fibrous, Texture Asbestos Types: Other Material: Non-fibrous 100 %			
2011120134RK-72	920111262-50	No	NAD
Location: School Sign At South Parking Lot, On Support Post / Texture Coat On Metal			(by CVES) by Johana Perez on 11/18/20
Analyst Description: Off-White\Red, Homogeneous, Non-Fibrous, Texture Asbestos Types: Other Material: Non-fibrous 100 %			
2011120134RK-73	920111262-51	No	NAD
Location: South Parking Lot, East / Asphalt Paving / South Parking Lot			(by CVES) by Johana Perez on 11/18/20
Analyst Description: Black, Homogeneous, Non-Fibrous, Asphalt Asbestos Types: Other Material: Cellulose 3 %, Non-fibrous 97 %			
2011120134RK-74	920111262-52	No	NAD
Location: South Parking Lot, East / Asphalt Paving			(by CVES) by Johana Perez on 11/18/20
Analyst Description: Black, Homogeneous, Non-Fibrous, Asphalt Asbestos Types: Other Material: Cellulose 3 %, Non-fibrous 97 %			
2011120134RK-75	920111262-53	No	NAD
Location: South Parking Lot, Center / Asphalt Paving			(by CVES) by Johana Perez on 11/18/20
Analyst Description: Black, Homogeneous, Non-Fibrous, Asphalt Asbestos Types: Other Material: Cellulose 3 %, Non-fibrous 97 %			

Client Name: Executive Environmental Services Corporation

PLM Bulk Asbestos Report

20-Z0046-0134; Building D (Room 13-16), Building E (Room 17-19), Building F (Rooms 20-23), Building H (Rooms 5-9), Restroom Building 1, Restroom Building 2, Covered Walkways, Campus

Client No. / HGA	Lab No.	Asbestos Present	Total % Asbestos
2011120134RK-76	920111262-54	No	NAD
Location: South Parking Lot, Center West / Asphalt Paving			(by CVES) by Johana Perez on 11/18/20
Analyst Description: Black, Homogeneous, Non-Fibrous, Asphalt Asbestos Types: Other Material: Cellulose 3 %, Non-fibrous 97 %			
2011120134RK-77	920111262-55	No	NAD
Location: South Parking Lot, West / Asphalt Paving			(by CVES) by Johana Perez on 11/18/20
Analyst Description: Black, Homogeneous, Non-Fibrous, Asphalt Asbestos Types: Other Material: Cellulose 3 %, Non-fibrous 97 %			
2011120134RK-78	920111262-56	No	NAD
Location: School Sign North By Building A (Admin Room 3), On Support Post / Texture Coat On Metal / School Sign North By Building A (Admin Room 3)			(by CVES) by Johana Perez on 11/18/20
Analyst Description: Off-White\Red, Homogeneous, Non-Fibrous, Texture Asbestos Types: Other Material: Non-fibrous 100 %			
2011120134RK-79	920111262-57	No	NAD
Location: School Sign North By Building A (Admin Room 3), On Support Post / Texture Coat On Metal			(by CVES) by Johana Perez on 11/17/20
Analyst Description: Off-White/Red, Homogeneous, Non-Fibrous, Texture Asbestos Types: Other Material: Non-fibrous 100 %			
2011120134RK-80	920111262-58	No	NAD
Location: School Sign North By Building A (Admin Room 3), On Support Post / Texture Coat On Metal			(by CVES) by Johana Perez on 11/17/20
Analyst Description: Off-White\Red, Homogeneous, Non-Fibrous, Texture Asbestos Types: Other Material: Non-fibrous 100 %			

Client Name: Executive Environmental Services Corporation

PLM Bulk Asbestos Report

20-Z0046-0134; Building D (Room 13-16), Building E (Room 17-19), Building F (Rooms 20-23), Building H (Rooms 5-9), Restroom Building 1, Restroom Building 2, Covered Walkways, Campus

Reporting Notes:

Analyzed By: Johana Perez ; Date Analyzed: 11/17/2020 11.17.20

*NAD = no asbestos detected; Detection Limit <1%; Reporting Limits: CVES = 1%, 400 Pt Ct = 0.25%, 1000 Pt Ct = 0.1%; NA = not analyzed; NA/PS = not analyzed / positive stop; NVA = No Visible Asbestos; PLM (polarized light microscopy) Bulk Asbestos Analysis by EPA 600/R-93/116, including requirements for EPA 600/M4-82-020 per 40 CFR 763 (NVLAP Lab #200346-0); Note: PLM is not consistently reliable in detecting asbestos in floor coverings and similar NOB materials. TEM is currently the only method that can be used to determine if this material can be considered or treated as non-asbestos-containing in New York State (also see EPA Advisory for floor tile, FR 59, 146, 38970, 8/1/94). NIST Accreditation requirements mandate that this report must not be reproduced except in full with the approval of the laboratory. This PLM report relates ONLY to the items tested.

Reviewed By: 



Please Reply To:

AmeriSci Los Angeles

24416 S. Main Street, Ste 308

Carson, California 90745

TEL: (310) 834-4868 • FAX: (310) 834-4772

FACSIMILE TELECOPY TRANSMISSION

To: Yesenia Galeana	From: Johana Perez
Executive Environmental Services Corporation	AmeriSci Job #: 920111329
Fax #:	Subject: PLM 1000 point count 48 hour Res
	Client Project: 20-Z0046-0134; Building D (Room 13-16), Building E (Room 17-19), Building F (Ro
Email: info@execenv.com,ygaleana@execenv.com	

Date: Friday, November 20, 2020

Time: 10:02:03

Comments:

Number of Pages: _____

(including cover sheet)

CONFIDENTIALITY NOTICE: Unless otherwise indicated, the information contained in this communication is confidential information intended for use of the individual named above. If the reader of this communication is not the intended recipient, you are hereby notified that any dissemination, distribution or copying of this communication is prohibited. If you have received this communication in error, please immediately notify the sender by telephone and return the original message to the above address via the US Postal Service at our expense. Samples are disposed of in 60 days or unless otherwise instructed by the protocol or special instructions in writing. Thank you.

Certified Analysis Service 24 Hours A Day • 7 Days A Week Competitive Prices

visit our web site - www.amerisci.com

Boston • Los Angeles • New York • Richmond

**AmeriSci Los Angeles**

24416 S. Main Street, Ste 308

Carson, California 90745

TEL: (310) 834-4868 • FAX: (310) 834-4772

PLM Bulk Asbestos ReportExecutive Environmental Services Corpo **Date Received** 11/18/20 **AmeriSci Job #** 920111329

Attn: Yesenia Galeana

Date Examined 11/20/20**P.O. #**

310 East Foothill Blvd.

Page 1 **of** 1

Suite 200

Arcadia, CA 91006

RE: 20-Z0046-0134; Building D (Room 13-16), Building E (Room 17-19), Building F (Rooms 20-23), Building H (Rooms 5-9), Restroom Building 1, Restroom Building 2, Covered Walkways, Campus

Client No. / HGA	Lab No.	Asbestos Present	Total % Asbestos
2011120134RK-40 01 Location: Exterior, North Wall / Exterior Stucco	920111329-01	Yes	Trace (<0.1 % pc) ¹ (by 1000 pt ct) by Johana Perez on 11/20/20
Analyst Description: Grey, Homogeneous, Non-Fibrous, Cementitious, Stucco Asbestos Types: Chrysotile <0.1 % pc Other Material: Non-Asbestos/Inert 66.9 %			
2011120134RK-41 01 Location: Exterior, East Wall / Exterior Stucco	920111329-02	Yes	Trace (<0.1 % pc) ¹ (by 1000 pt ct) by Johana Perez on 11/20/20
Analyst Description: Grey, Homogeneous, Non-Fibrous, Cementitious, Stucco Asbestos Types: Chrysotile <0.1 % pc Other Material: Non-Asbestos/Inert 75.4 %			
2011120134RK-42 01 Location: Exterior, Overhang - SE / Exterior Stucco	920111329-03	Yes	Trace (<0.1 % pc) ¹ (by 1000 pt ct) by Johana Perez on 11/20/20
Analyst Description: Grey, Homogeneous, Non-Fibrous, Cementitious, Stucco Asbestos Types: Chrysotile <0.1 % pc Other Material: Non-Asbestos/Inert 71 %			

Reporting Notes:

(1) EPA 1000 Point Count Analysis performed on inert residue remaining after 480C heat and HCl acid treatments.

Analyzed By: Johana Perez *[Signature]*; Date Analyzed: 11/20/2020 *11/20/20*

*NAD = no asbestos detected; Detection Limit <1%; Reporting Limits: CVES = 1%, 400 Pt Ct = 0.25%, 1000 Pt Ct = 0.1%; NA = not analyzed; NA/PS = not analyzed / positive stop; NVA = No Visible Asbestos; PLM (polarized light microscopy) Bulk Asbestos Analysis by EPA 600/R-93/116, including requirements for EPA 600/M4-82-020 per 40 CFR 763 (NVLAP Lab #200346-0); Note: PLM is not consistently reliable in detecting asbestos in floor coverings and similar NOB materials. TEM is currently the only method that can be used to determine if this material can be considered or treated as non-asbestos-containing in New York State (also see EPA Advisory for floor tile, FR 59, 146, 38970, 8/1/94). NIST Accreditation requirements mandate that this report must not be reproduced except in full with the approval of the laboratory. This PLM report relates ONLY to the items tested.

Reviewed By: *[Signature]*



Industrial Hygiene Laboratory Submittal Asbestos -- PLM

Originating Office
☒ 310 E. Foothill Blvd., Suite 200
Arcadia, CA 91006
Phone: 626.441.7050
Fax: 626.441.0016

Lab Submitted to:
☒ AmeriSci
☐ EMLab (Glendale)
☐ LA Testing

<input type="checkbox"/> Routine (5 Days) <input type="checkbox"/> RUSH (surcharges may apply) Circle One 6 hours 24 hours 48 hours 3 to 5 days	Project #: 20-Z0046-0134	Sampled by: Tim Galeana/Rhys Kuzmic	Site Zip Code: 91770	Sample Date: 11/12/2020	Page 5 of 5
---	------------------------------------	---	--------------------------------	-----------------------------------	--------------------

The receiving Laboratory is required to complete the following:

- All invoices are to be sent to: 310 E. Foothill Blvd., Suite 200, Arcadia, CA 91006 with a copy of the lab report.
- Analyze all samples by PLM by EPA 600/R-93/116.
- Stop analysis of homogeneous groups at first positive that is greater than or equal to 1.0%

Building Name: Building D (Rooms 13-16)

- All lab reports and invoices are to contain the Project Number from above.
- Unsigned and reports marked draft are unacceptable.
- Report to the attention of: Yesenia Galeana, Phone: (562) 889-1327

Optional Items to be completed by the laboratory (if check marked): ☒ Email Report to: Info@execenv.com ☒ Other: ygaleana@execenv.com; ☐ US Mail Report to: ☐ Originating office check marked above ☐ Other: ☐ Alternate billing address: 920112002

Sample No.:	Sample Location - Include Room information where appropriate	Material Description	Homogeneous Location	No.	Quantity	Percent Damaged
-23	Exterior, south wall	Exterior stucco	T-0 exterior walls and west breezeway	5	3,500 SF	<1
-24	Exterior, east wall					
-25	Exterior, north wall					
-26	Exterior, west wall					
-27	Exterior, west breezeway ceiling - SE					

Prefix: 201120134RH

Notes:

Released By, Date: Rhys, 11/13/2020 2:45PM

Received By, Date, & Time:

Released By, Date, & Time:

Rhys 11/13/20 1445



Originating Office <input checked="" type="checkbox"/> 310 E. Foothill Blvd., Suite 200 Arcadia, CA 91006 Phone: 626.441.7050 Fax: 626.441.0016	Lab Submitted to: <input checked="" type="checkbox"/> AmeriSci <input type="checkbox"/> EMLab (Glendale) <input type="checkbox"/> LA Testing
--	--

☐ Routine (5 Working Days)

☐ **RUSH** (surcharges may apply)
 Circle 6 24 48 340 5
 One hours hours hours days

Project #:
20-Z004

Sampled
Tim C

zmic

Site Zip Code:
91770

Sample Date: 11/12/2020

The receiving Laboratory is required to complete the following:

1. All invoices are to be sent to: 310 E. Foothill Blvd., Suite 200, Arcadia, CA 91006 with a copy of the lab report.
2. Analyze all samples by PLM by EPA 600/R-93/116.
3. Stop analysis of homogeneous groups at first positive that is greater than or equal to 1.0%
4. All lab reports and invoices are to contain the Project Number from above.
5. Unsigned and reports marked draft are unacceptable.
6. Report to the attention of: Yesenia Galeana, Phone: (562) 889-1327

Optional items to be completed by the laboratory (if check marked): ☒ Email Report to: ☒ Info@execenv.com ☒ Other: ☒ ygaileana@execenv.com

☒ US Mail Report to: ☒ Originating office check marked above ☐ Other:

☐ Alternate billing address:

92011262

Sample No.:	Sample Location - Include Room information where appropriate	Material Description	Homogeneous Location	No.	Quantity	Percent Damaged
-28	Exterior, North wall - west end	Exterior stud	To exterior walls	6	3,000 SF	<1
-29	Exterior, West wall					
-30	Exterior, South wall					
-31	Exterior, east wall					
-32	Exterior, North wall - east end					

Notes:

By, Date,

Don Ku 11/13/2020 2:45PM

Received
By, Date,
& Time::

Released
By, Date,
& Time:

Page 11/13/20 1445

☐ Routine (5 Days)
☐ RUSH (surcharges may apply)
 Circle 6 24 48 hours days

Project #:
20-Z0046-0134

Sampled by:
Tim Galeana/Rhys Kuzmic

Site Zip Code:
91770

Sample Date:
11/12/2020

Page 7 of 15

Building Name: BUILDING F (Rooms 20-23)

4. All lab reports and invoices are to contain the Project Number from above.
 5. Unsigned and reports marked draft are unacceptable.
 6. Report to the attention of: Yesenia Galeana, Phone: (562) 889-1327

Optional Items to be completed by the laboratory (if check marked): ☒ Email Report to: Info@execenv.com ☒ Other: ygaleana@execenv.com;
☒ US Mail Report to: ☒ Originating office check marked above ☐ Other:
☐ Alternate billing address: 92011262

Sample No.:	Sample Location - Include Room information where appropriate	Material Description	Homogeneous Location	No.	Quantity	Percent Damaged
-33	Exterior, south wall	Exterior stucco	T-O exterior walls and west breezeway	7	3,500 SF	<1
-34	Exterior, east wall					
-35	Exterior, north wall					
-36	Exterior, west wall					
-37	Exterior, west breezeway ceiling - SE					



Industrial Hygiene Laboratory Submittal Asbestos -- PLM

Originating Office
☒ 310 E. Foothill Blvd., Suite 200
Arcadia, CA 91006
Phone: 626.441.7050
Fax: 626.441.0016

Lab Submitted to:
☒ AmeriSci
☐ EMLab (Glendale)
☐ LA Testing

☐ Routine (5 Days)
☐ Rush (surcharges may apply)
Circle 6 24 48 hours days

Project #: 20-Z0046-0134

Sampled by: Tim Galeana/Rhys Kuzmic

Site Zip Code: 91770

Sample Date: 11/12/2020

Pages of 15

The receiving Laboratory is required to complete the following:

1. All invoices are to be sent to: 310 E. Foothill Blvd., Suite 200, Arcadia, CA 91006 with a copy of the lab report.
2. Analyze all samples by PLM by EPA 600/R-93/116.
3. Stop analysis of homogeneous groups at first positive that is greater than or equal to 1.0%

Building Name: Building H (Rooms 5-9)

4. All lab reports and invoices are to contain the Project Number from above.
5. Unsigned and reports marked draft are unacceptable.
6. Report to the attention of: Yessenia Galeana, Phone: (562) 889-1327

Optional Items to be completed by the laboratory (if check marked): ☒ Email Report to: Info@execenv.com ☒ Other: ygaleana@execenv.com
☒ US Mail Report to: ☒ Originating office check marked above ☐ Other: 92011262
☐ Alternate billing address:

Sample No.:	Sample Location - Include Room information where appropriate	Material Description	Homogeneous Location	No.	Quantity	Percent Damaged
-38	Exterior, south wall	Exterior stucco	To exterior walls (select walls - some are crumbling) and overhang	8	4,500 SF	<1
-39	Exterior, west wall			1		
-40	Exterior, north wall			1		
-41	Exterior, east wall			1		
-42	Exterior, overhang - SE			1		

Prefix: 201126292K

Notes:

Released By, Date: 11/13/2020 2:45PM
Received By, Date: & Time:

Released By, Date: & Time: 11/13/20 1445



Industrial Hygiene Laboratory Submittal
Asbestos -- PLM

Originating Office
☒ 310 E. Foothill Blvd., Suite 200
Arcadia, CA 91006
Phone: 626.441.7050
Fax: 626.441.0016

Lab Submitted to:
☒ AmeriSci
☐ EMLab (Glendale)
☐ LA Testing

☐ Routine (5 Days)
☐ RUSH (surcharges may apply)
Circle 6 24 48 hours days

Project #: 20-Z0046-0134

Sampled by: Tim Galeana/Rhys Kuzmic

Site Zip Code: 91770

Sample Date: 11/12/2020
Page 9 of 15

The receiving Laboratory is required to complete the following:

1. All invoices are to be sent to: 310 E. Foothill Blvd., Suite 200, Arcadia, CA 91006 with a copy of the lab report.
2. Analyze all samples by PLM by EPA 600/R-93/116.
3. Stop analysis of homogeneous groups at first positive that is greater than or equal to 1.0%

Building Name: Restroom Building 1

4. All lab reports and invoices are to contain the Project Number from above.
5. Unsigned and reports marked draft are unacceptable.
6. Report to the attention of: Yesenia Galeana, Phone: (562) 889-1327

Optional items to be completed by the laboratory (if check marked): ☒ Email Report to: Info@execenv.com ☒ Other: vgaleana@execenv.com

☒ US Mail Report to: ☒ Originating office check marked above ☐ Other:

☐ Alternate billing address:

020111262

Sample No.:	Sample Location - Include Room information where appropriate	Material Description	Homogeneous Location	No.	Quantity	Percent Damaged
-43	Exterior, South Wall	Exterior stucco	T-O exterior walls and west breezeway	9	1200 SF	<1
-44	Exterior, North Wall			1		
-45	Exterior, West Wall			1		
-46	Exterior, East Wall			1		
-47	Exterior, West breezeway ceiling - SF			1		

Prefix: 201120134R

Notes:

Released By, Date: 11/13/2020 2:45PM

Received By, Date: & Time:

Released By, Date: 11/12/20 1445



Industrial Hygiene Laboratory Submittal Asbestos -- PLM

Originating Office
☒ 310 E. Foothill Blvd., Suite 200
Arcadia, CA 91006
Phone: 626.441.7050
Fax: 626.441.0016

Lab Submitted to:
☒ AmeriSci
☐ EMLab (Glendale)
☐ LA Testing

<input type="checkbox"/> Routine (5 Days)	<input type="checkbox"/> RUSH (surcharges may apply) Circle 6 24 48 3 to 5 One hours hours days	Project #: 20-Z0046-0134	Sampled by: Tim Galeana/Rhys Kuzmic	Site Zip Code: 91770	Sample Date: 11/12/2020	Page 10 of 15
--	---	------------------------------------	---	--------------------------------	-----------------------------------	----------------------

The receiving Laboratory is required to complete the following:

- All invoices are to be sent to: 310 E. Foothill Blvd., Suite 200, Arcadia, CA 91006 with a copy of the lab report.
- Analyze all samples by PLM by EPA 600/R-93/116.
- Stop analysis of homogeneous groups at first positive that is greater than or equal to 1.0%

Optional Items to be completed by the laboratory (if check marked): ☒ Email Report to: Info@execenv.com ☒ Other: ygalearna@execenv.com;
☒ US Mail Report to: ☒ Originating office check marked above ☐ Other: Info@execenv.com

Sample No.:	Sample Location - Include Room information where appropriate	Material Description	Homogeneous Location	No.	Quantity	Percent Damaged
-48	Exterior, north wall	Exterior stucco	TO exterior walls and west breezeway	10	1200sf	<1
-49	Exterior, south wall					
-50	Exterior, east wall					
-51	Exterior, west wall					
-52	Exterior, west breezeway ceiling - SF					

Prefix: 2011201342K

Notes:

Released By, Date: 11/13/2020 2:45PM	Received By, Date: 11/13/2020 2:45PM
Released By, Date: 11/13/2020 2:45PM	Received By, Date: 11/13/2020 2:45PM

Rev. 1/19 ©Copyright 2019 All Rights Reserved Form: AL-006PLM



Industrial Hygiene Laboratory Submittal Asbestos -- PLM

Originating Office
☒ 310 E. Foothill Blvd., Suite 200
Arcadia, CA 91006
Phone: 626.441.7050
Fax: 626.441.0016

Lab Submitted to:
☒ AmeriSci
☐ EMLab (Glendale)
☐ LA Testing

<input type="checkbox"/> Routine (5 Days) <input type="checkbox"/> Working One	<input type="checkbox"/> RUSH (surcharges may apply) Circle 6 24 48 hours hours days	Project #: 20-Z0046-0134	Sampled by: Tim Galeana/Rhys Kuzmic	Site Zip Code: 91770	Sample Date: 11/12/2020	Page 11 of 15
---	---	-----------------------------	--	-------------------------	----------------------------	---------------

Building Name: Covered Walkways

The receiving Laboratory is required to complete the following:

- All invoices are to be sent to: 310 E. Foothill Blvd., Suite 200, Arcadia, CA 91006 with a copy of the lab report.
- Analyze all samples by PLM by EPA 600/R-93/116.
- Stop analysis of homogeneous groups at first positive that is greater than or equal to 1.0%

Optional items to be completed by the laboratory (if check marked): ☒ Email Report to: Info@execenv.com ☒ Other: ygaleana@execenv.com
☒ US Mail Report to: ☒ Originating office check marked above ☐ Other: ☐ Alternate billing address: 920112602

Sample No.:	Sample Location - Include Room information where appropriate	Material Description	Homogeneous Location	No.	Quantity	Percent Damaged
-53	Covered Walkway > exterior, east wall - north side	Exterior stucco	Covered Walkway > walls	11	200 SF	< 1
-54	Covered Walkway > exterior, south side wall	↓		↓	↓	↓
-55	Covered Walkway > exterior, west wall - south side	↓		↓	↓	↓
-56	Covered Walkway 10 exterior, east wall - east side	Exterior stucco	Covered Walkway 10 walls	12	200 SF	< 1
-57	Covered Walkway 10 exterior, east wall - south side	↓		↓	↓	↓
-58	Covered Walkway 10 exterior, west wall - north side	↓		↓	↓	↓

Prefix: 201120134R

Notes:	Received By, Date, & Time:	Released By, Date, & Time:
Rhys Kuz 11/13/2020 2:45PM		By 11/13/20 1445
Rev. 1/19	©Copyright 2019 All Rights Reserved	Form: AL-006PLM



Industrial Hygiene Laboratory Submittal Asbestos -- PLM

Originating Office
☒ 310 E. Foothill Blvd., Suite 200
Arcadia, CA 91006
Phone: 626.441.7050
Fax: 626.441.0016

Lab Submitted to:
☒ AmeriSci
☐ EMLab (Glendale)
☐ LA Testing

☐ Routine (5 Days)
☐ Working
☐ RUSH (surcharges may apply)
Circle 6 24 48 hours hours days

Project #:
20-Z0046-0134

Sampled by:
Tim Galeana/Rhys Kuzmic

Site Zip Code:
91770

Sample Date:
11/12/2020

Page 2 of 15

The receiving Laboratory is required to complete the following:

- All invoices are to be sent to: 310 E. Foothill Blvd., Suite 200, Arcadia, CA 91006 with a copy of the lab report.
- Analyze all samples by PLM by EPA 600/R-93/116.
- Stop analysis of homogeneous groups at first positive that is greater than or equal to 1.0%

Building Name: Campus

- All lab reports and invoices are to contain the Project Number from above.
- Unsigned and reports marked draft are unacceptable.
- Report to the attention of: Yesenia Galeana, Phone: (562) 889-1327

Optional Items to be completed by the laboratory (if check marked): ☒ Email Report to: Info@execenv.com ☒ Other: vgaleana@execenv.com

☒ US Mail Report to: ☒ Originating office check marked above ☐ Other:

☐ Alternate billing address:

Sample No.:	Sample Location - Include Room information where appropriate	Material Description	Homogeneous Location	No.	Quantity	Percent Damaged
-59	Kindergarten playground, SE	Asphalt Paving	Kindergarten playground	13	2700 SF	< 1
-60	Kindergarten playground, SW					
-61	Kindergarten playground, north					
-62	South Playground, SE	Asphalt Paving	South playground	14	23,000 SF	< 1
-63	South Playground, west of Portabic 25					
-64	South Playground, near center					
-65	South Playground, SW					
-66	South Playground, NW					

Prefix: 201120134RK

Notes:

Released By, Date: Rhys Kuz 11/13/2020 2:45PM

Received By, Date, & Time:

Released By, Date, & Time:

11/13/20 1405



Industrial Hygiene Laboratory Submittal Asbestos -- PLM

Originating Office
☒ 310 E. Foothill Blvd., Suite 200
Arcadia, CA 91006
Phone: 626.441.7050
Fax: 626.441.0016

Lab Submitted to:
☒ AmeriSci
☐ EMLab (Glendale)
☐ LA Testing

☐ Routine (5 Days)
☐ Working One day
☒ RUSH (surcharges may apply) 3 to 5 days

Project #:
20-Z0046-0134

Sampled by:
Tim Galeana/Rhys Kuzmic

Site Zip Code:
91770

Sample Date:
11/12/2020

Page 13 of 15

The receiving Laboratory is required to complete the following:

- All invoices are to be sent to: 310 E. Foothill Blvd., Suite 200, Arcadia, CA 91006 with a copy of the lab report.
- Analyze all samples by PLM by EPA 600/R-93/116.
- Stop analysis of homogeneous groups at first positive that is greater than or equal to 1.0%

Building Name: Camp Davis

Optional items to be completed by the laboratory (if check marked): ☒ Email Report to: Info@execenv.com ☒ Other: ygaleana@execenv.com; ☐ Alternate billing address: 92011262

☒ US Mail Report to: ☒ Originating office check marked above ☐ Other:

Sample No.:	Sample Location - Include Room information where appropriate	Material Description	Homogeneous Location	No.	Quantity	Percent Damaged
-67	Driveway to South Parking Lot NE	Asphalt pavings	Driveway to South Parking Lot	15	3900 SF	<1
-68	Driveway to South Parking Lot NE					
-69	Driveway to South Parking Lot NE					
-70	School sign at South Parking Lot on support post	Texture coat on metal	School sign at South Parking Lot	16	60 SF	<1
-71	School sign at South Parking Lot on support post					
-72	School sign at South Parking Lot on support post					

Prefix: 2011201342K

Notes:
By Date: 11/13/2020 2:45PM
Released By Date: 11/13/2020 1445

Received By Date: 11/13/2020 2:45PM

Released By Date: 11/13/2020 1445



Originating Office	Lab Submitted to:
<input checked="" type="checkbox"/> 310 E. Foothill Blvd., Suite 200 Arcadia, CA 91006 Phone: 626.441.7050 Fax: 626.441.0016	<input checked="" type="checkbox"/> AmeriSci <input type="checkbox"/> EMLab (Glendale) <input type="checkbox"/> LA Testing

Lab Submitted to:

☒ 310 E. Foothill Blvd., Suite 200
Arcadia, CA 91006
Phone: 626.441.7050
Fax: 626.441.0016

☐ Routine
(5 Working Days)

☐ **RUSH** (surcharges may apply):
 Circle 6 24 48
 One hours hours hours

Project #:
20-Z004

•

Sampled by:
Tim Galea

s Kuzmich

770
Zip Code:

2020
e Date:

The receiving Laboratory is required to complete the following:

1. All invoices are to be sent to: 310 E. Foothill Blvd., Suite 200, Arcadia, CA 91006 with a copy of the lab report.
2. Analyze all samples by PLM by EPA 600/R-93/116.
3. Stop analysis of homogeneous groups at first positive that is greater than or equal to 1.0%
4. All lab reports and invoices are to contain the Project Number from above.
5. Unsigned and reports marked draft are unacceptable.
6. Report to the attention of: Yesenia Galeana, Phone: (562) 889-1327

☒ Email Report to: ☒ Info@execenv.com

☒ U.S. Mail Bond to: ☒ Originating office check marked above ☐ Other: ☐ Alternate billing address:

02911762

Sample No.:	Sample Location - Include Room Information where appropriate	Material Description	Homogeneous Location	No.	Quantity	Percent Damaged
-73	South Parking Lot, east	Asphalt paving	South Parking Lot	17	33,000 SF	<1
-74	South Parking Lot, east	↓		↓	↓	↓
-75	South Parking Lot, center			↓	↓	↓
-76	South Parking Lot, center-west			↓	↓	↓
-77	South Parking Lot, west	↓		↓	↓	↓

Notes:

Released By: Date: & Time: Rm K 11/13/2020 2:45PM

Received By, Date, & Time:	Released By, Date, & Time:
----------------------------------	----------------------------------

of 11/10/20 1445

Rev. 1/19

©Copyright 2019 All Rights Reserved

Form: AL-006PLM



APPENDIX B – SAMPLE LOCATIONS DRAWINGS

Janson Elementary School

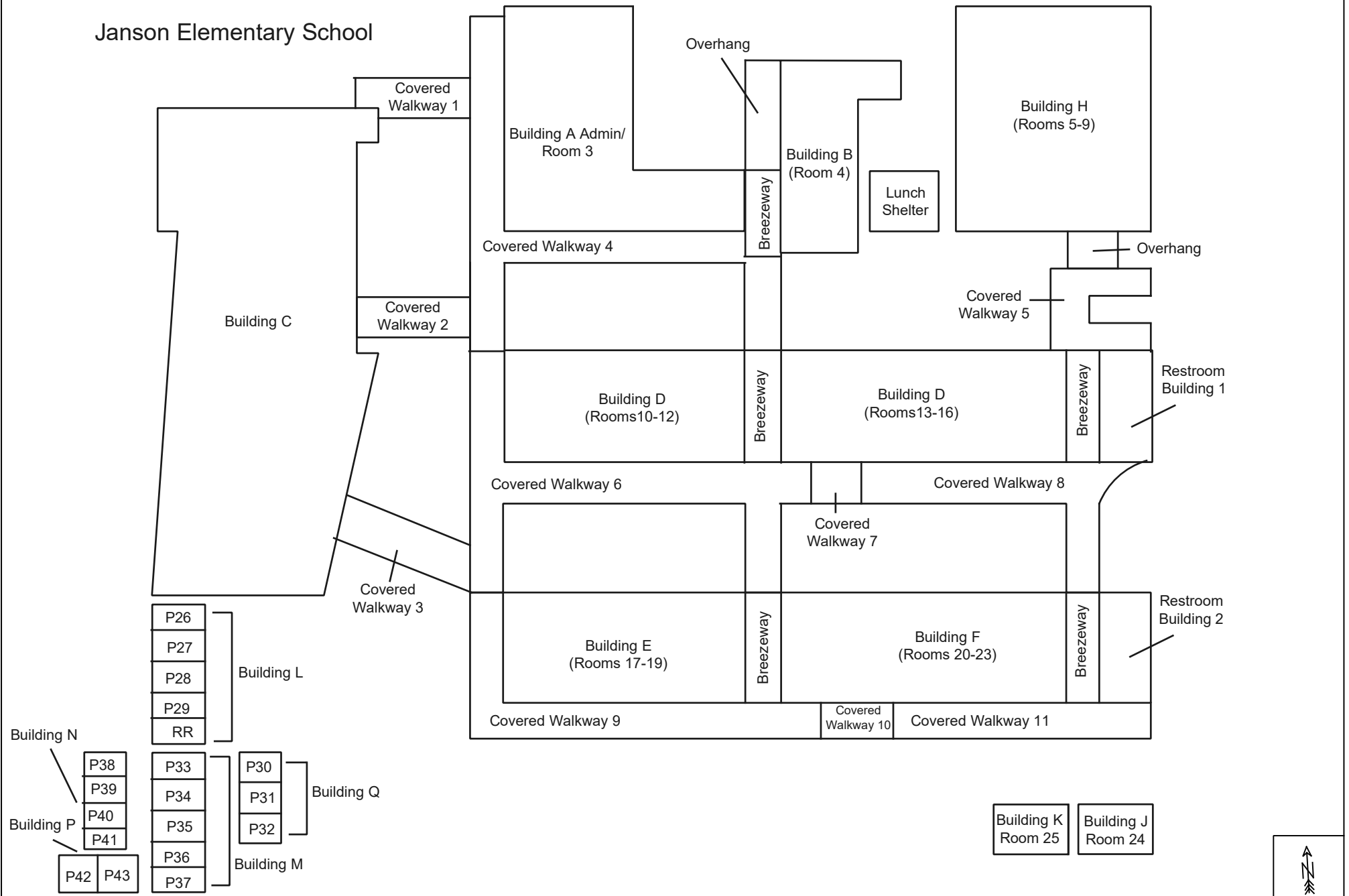

Client: Rosemead SD

Project #: 20-Z0046-0134

Info: Site Map



EXECUTIVE ENVIRONMENTAL
HEALTH & SAFETY SIMPLIFIED

Site: Janson Elementary School
Address: 8628 Marshall Street
Rosemead, California, 91170

Drawing Not to Scale - © 2012

Administration Building/Room 3
Exterior

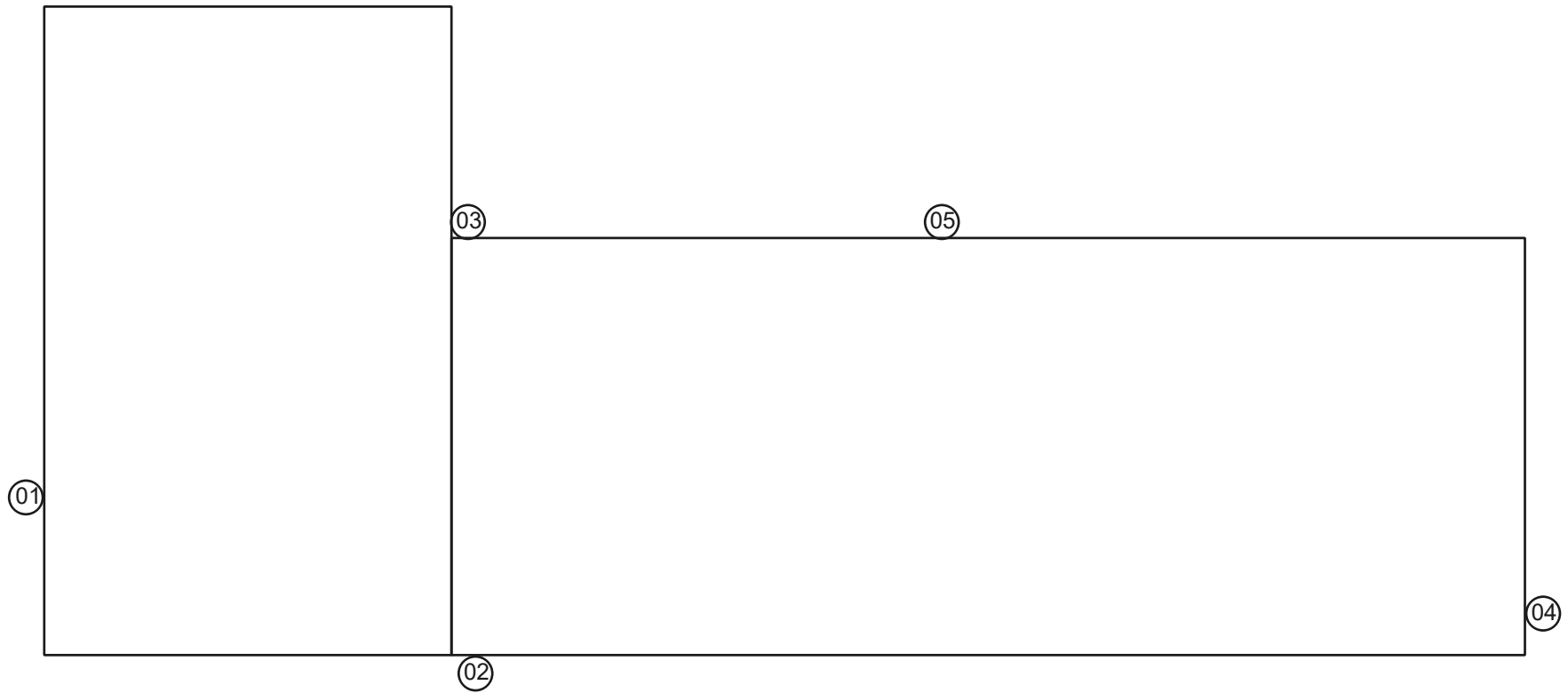

○ - PLM Sample Location



Client: Rosemead SD

Project #: 20-Z0046-0134

Info: PLM Sample Location



EXECUTIVE ENVIRONMENTAL
HEALTH & SAFETY SIMPLIFIED

Site: Janson Elementary School
Address: 8628 Marshall Avenue
Rosemead, California, 91170

Drawing Not to Scale - © 2012

Building B (Room 4)
Exterior

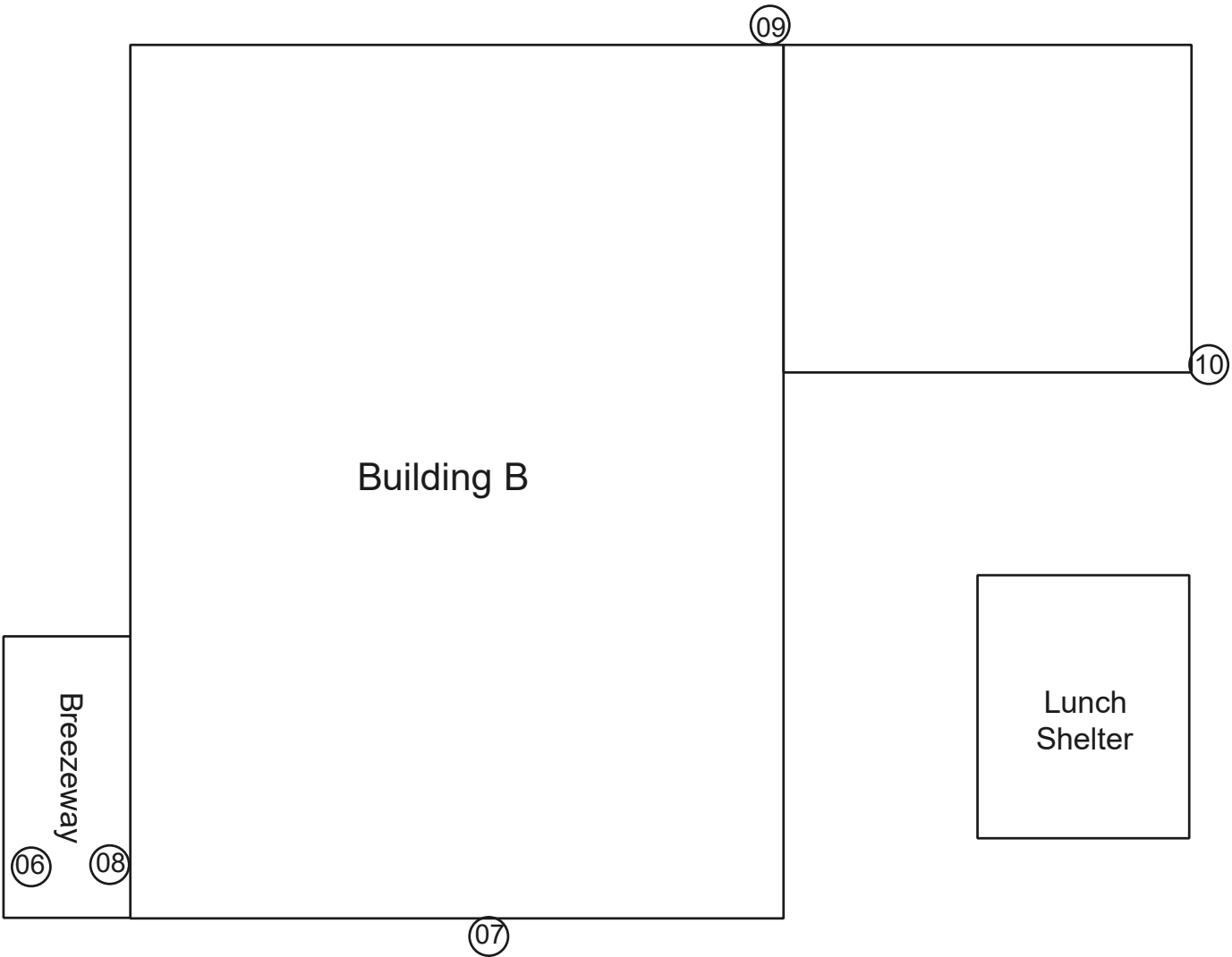

○ - PLM Sample Location



Building C Exterior

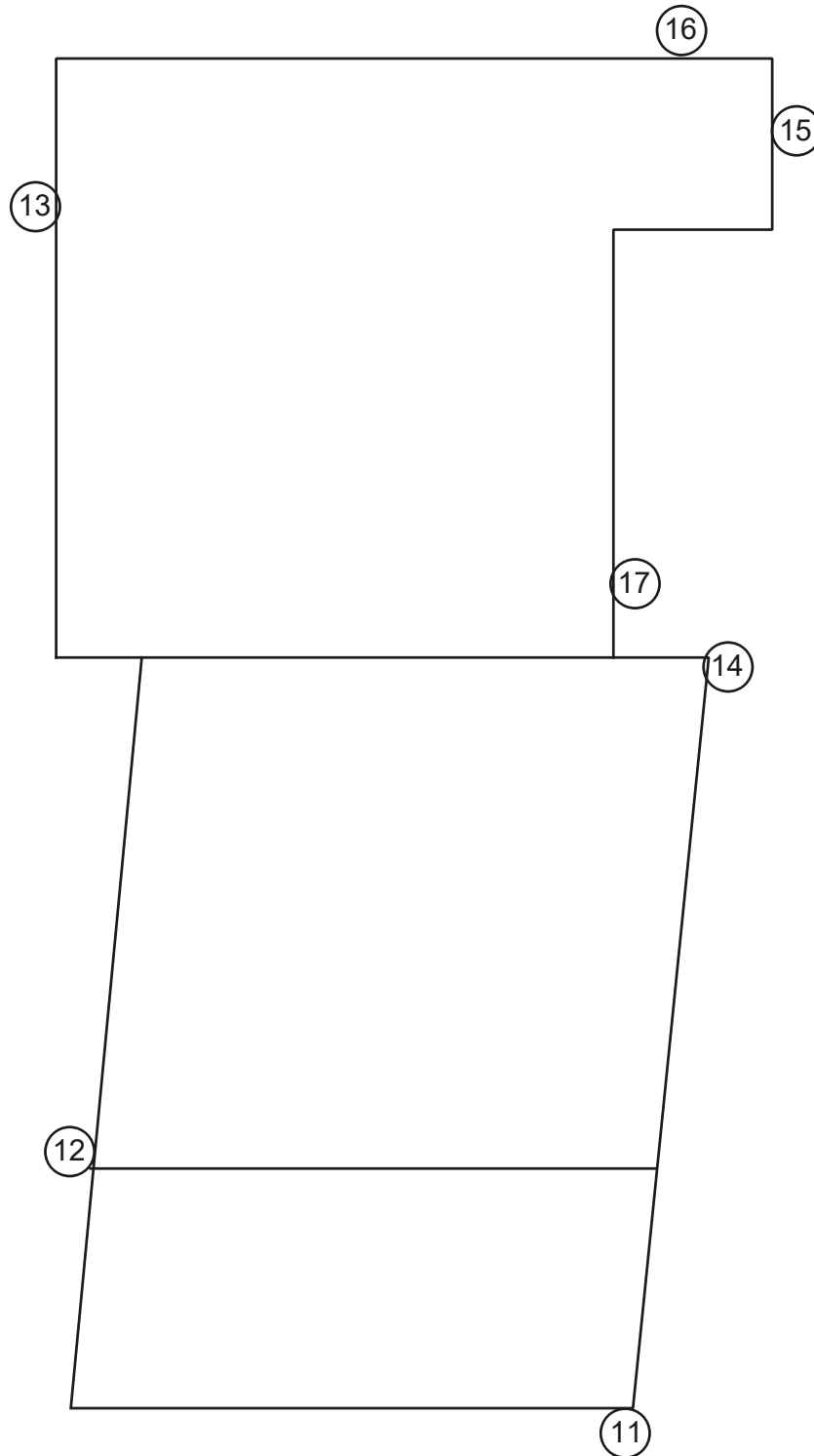

○ - PLM Sample Location



Client: Rosemead SD

Project#: 20-Z0046-0134

Info: PLM Sample Location



EXECUTIVE ENVIRONMENTAL
HEALTH & SAFETY SIMPLIFIED

Site: Janson Elementary School
Address: 8628 Marshall Avenue
Rosemead, CA 91770

Drawing Not to Scale - © 2012

Building D (Rooms 10 through 12)

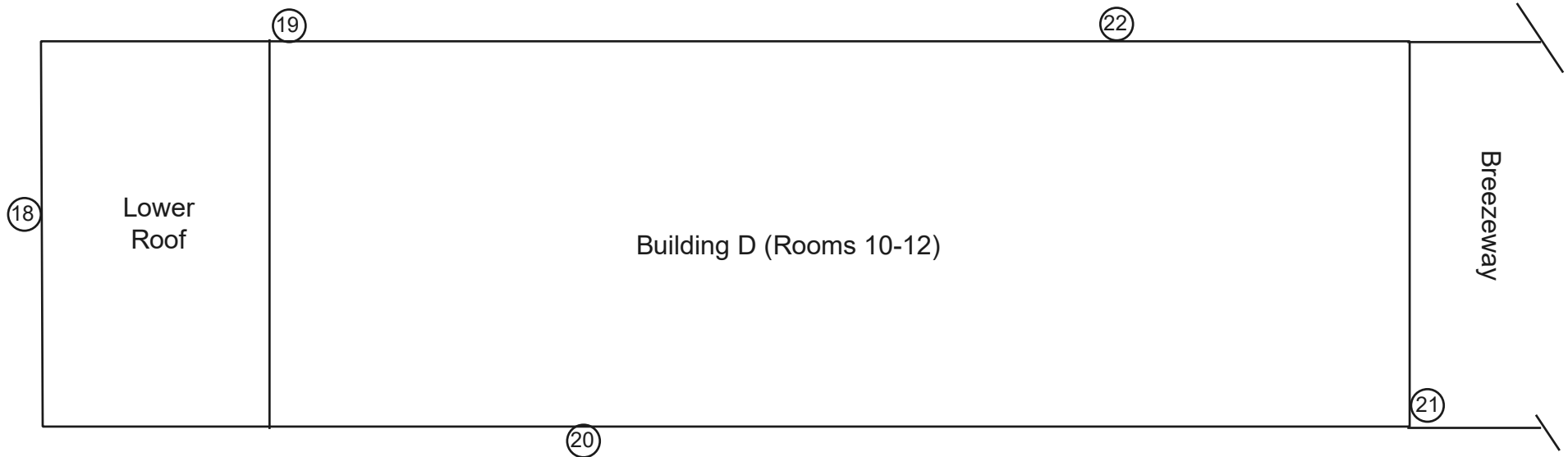

○ - PLM Sample Location



Client: Rosemead SD

Project #: 20-Z0046-0134

Info: PLM Sample Location



EXECUTIVE ENVIRONMENTAL
HEALTH & SAFETY SIMPLIFIED

Site: Janson Elementary School
Address: 8628 Marshall Avenue
Rosemead, California, 91170

Drawing Not to Scale - © 2012

Building D (Rooms 13 through 16) Exterior

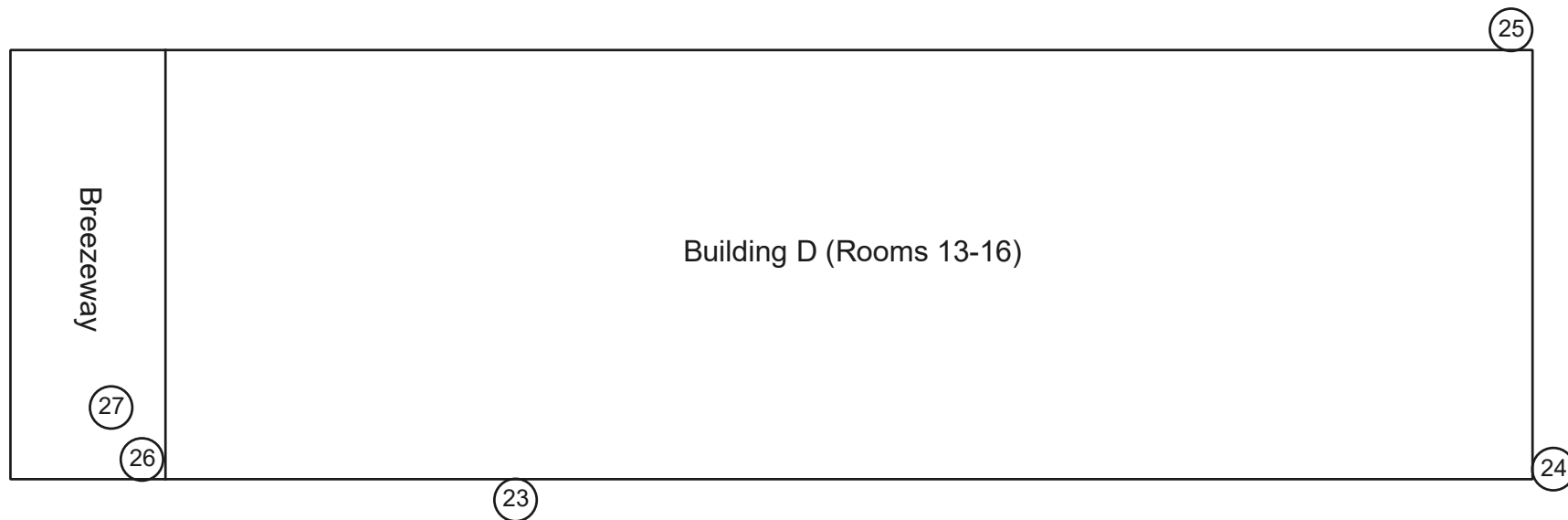

○ - PLM Sample Location



Client: Rosemead SD

Project #: 20-Z0046-0134

Info: PLM Sample Locations



EXECUTIVE ENVIRONMENTAL
HEALTH & SAFETY SIMPLIFIED

Site: Janson Elementary School
Address: 8628 Marshall Avenue
Rosemead, California, 91170

Drawing Not to Scale - © 2012

Building E (Rooms 17 through 19)
Exterior

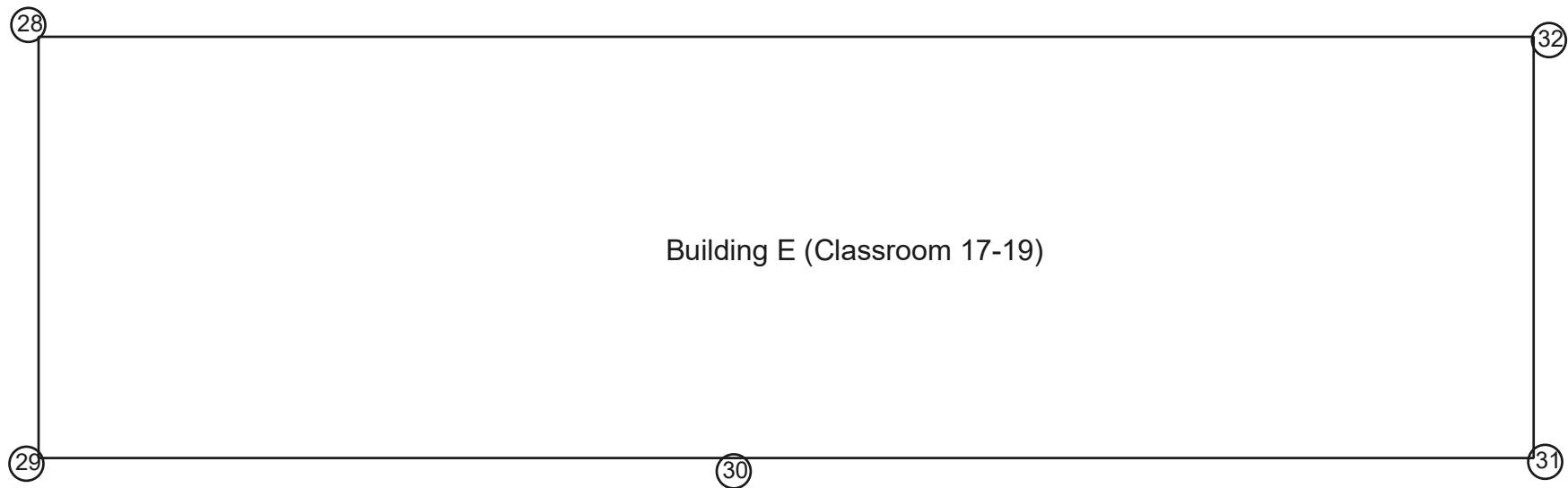

○ - PLM Sample Location



Client: Rosemead SD

Project #: 20-Z0046-0134

Info: PLM Sample Locations



EXECUTIVE ENVIRONMENTAL
HEALTH & SAFETY SIMPLIFIED

Site: Janson Elementary School
Address: 8628 Marshall Avenue
Rosemead, California, 91170

Drawing Not to Scale - © 2012

Building F (Rooms 20 through 23)
Exterior

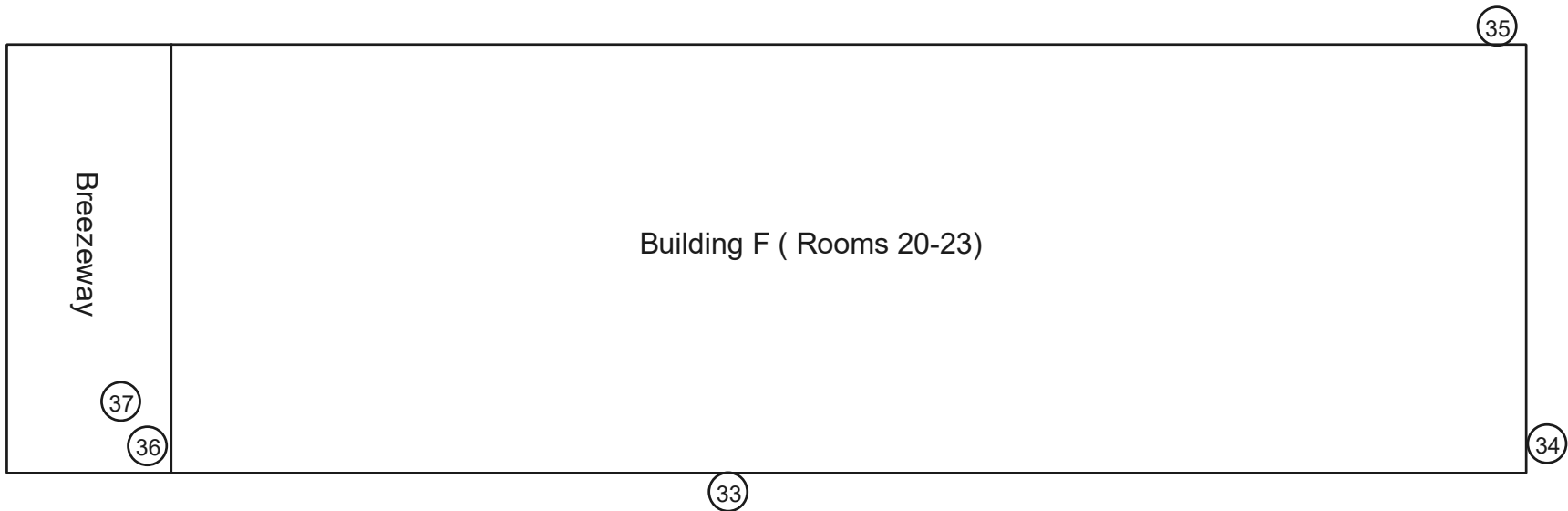

○ - PLM Sample Location



Client: Rosemead SD

Project #: 20-Z0046-0134

Info: PLM Sample Location



EXECUTIVE ENVIRONMENTAL
HEALTH & SAFETY SIMPLIFIED

Site: Janson Elementary School
Address: 8628 Marshall Avenue
Rosemead, California, 91170

Drawing Not to Scale - © 2012

Building H (Rooms 5 through 9)
Exterior

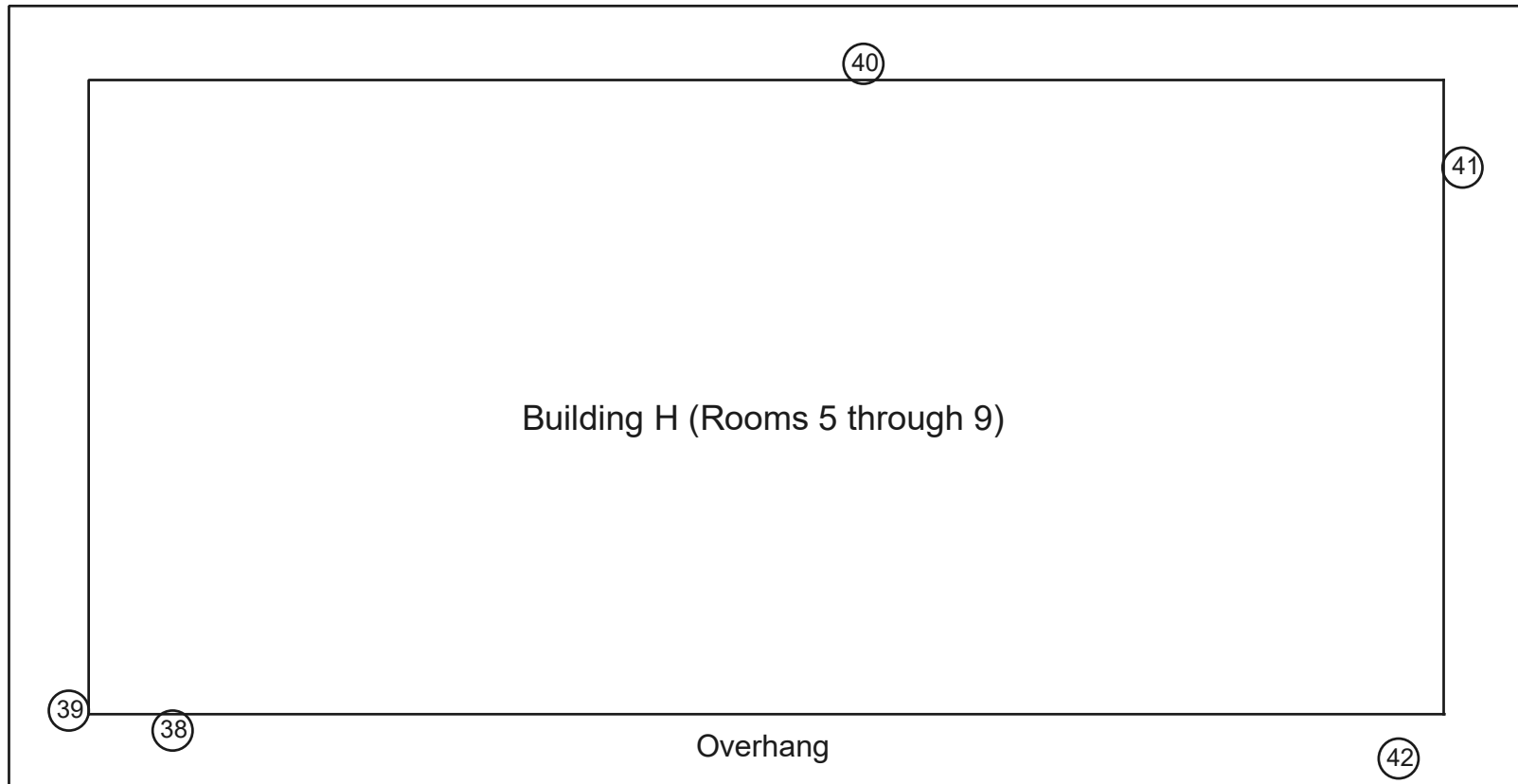

○ - PLM Sample Location



Client: Rosemead SD

Project #: 20-Z0046-0134

Info: PLM Sample Location



EXECUTIVE ENVIRONMENTAL
HEALTH & SAFETY SIMPLIFIED

Site: Janson Elementary School
Address: 8628 Marshall Avenue
Rosemead, California, 91170

Drawing Not to Scale - © 2012

Restroom Building 1
Exterior

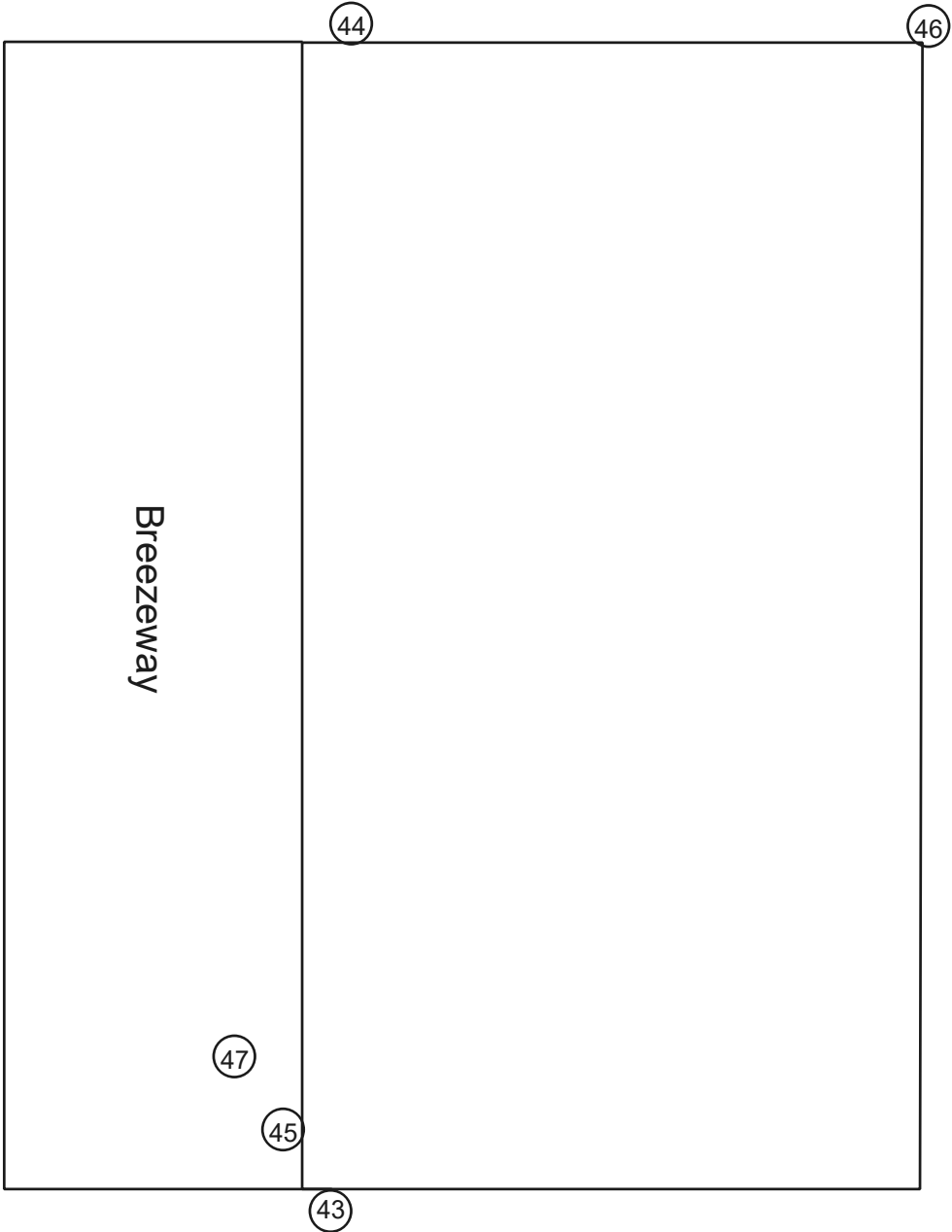

○ - PLM Sample Location



Restroom Building 2
Exterior

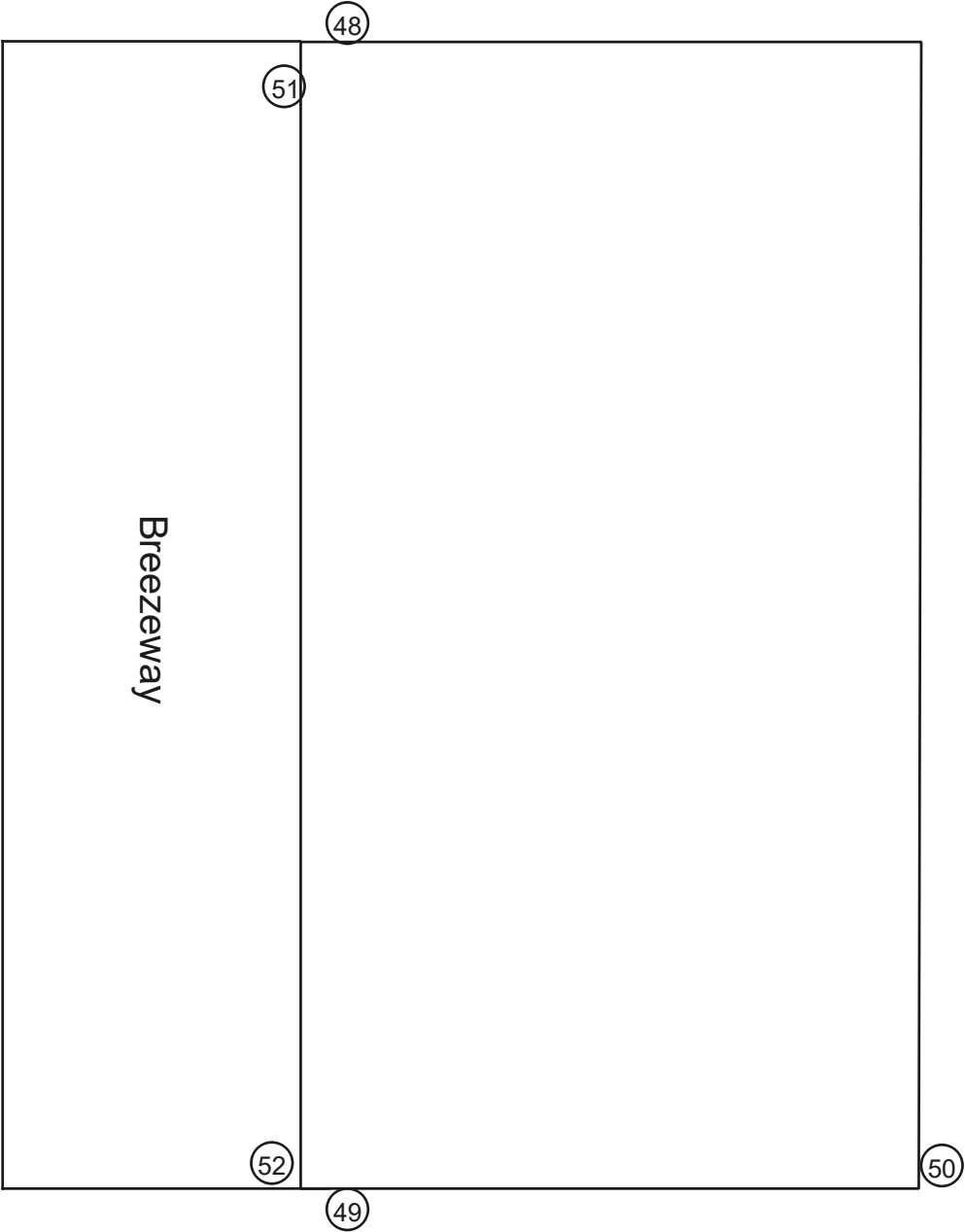

○ - PLM Sample Location



Client: Rosemead SD

Project#: 20-Z0046-0134

Info: PLM Sample Location



EXECUTIVE ENVIRONMENTAL
HEALTH & SAFETY SIMPLIFIED

Site: Janson Elementary School
Address: 8628 East Marshall Avenue
Rosemead, CA 91770

Drawing Not to Scale - © 2012

Janson Elementary School Site Map/Covered Walkways

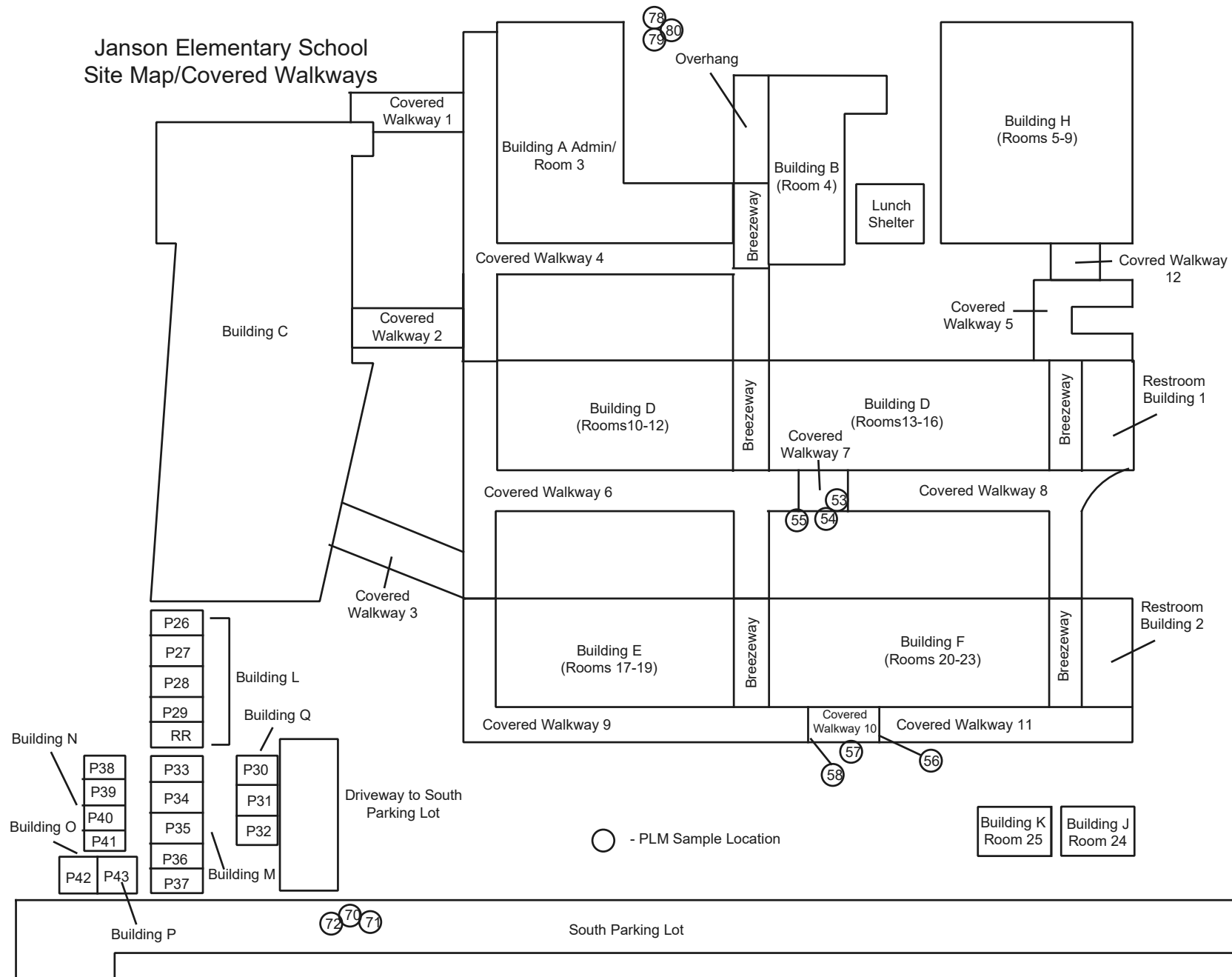

Client: Rosemead SD

Project #: 20-Z0046-0134

Info: PLM Sample Location



EXECUTIVE ENVIRONMENTAL
HEALTH & SAFETY SIMPLIFIED

Site: Janson Elementary School
Address: 8628 Marshall Avenue
Rosemead, California, 91170

Drawing Not to Scale - © 2012

Janson Elementary School Asphalt Samples

○ - PLM Sample Location

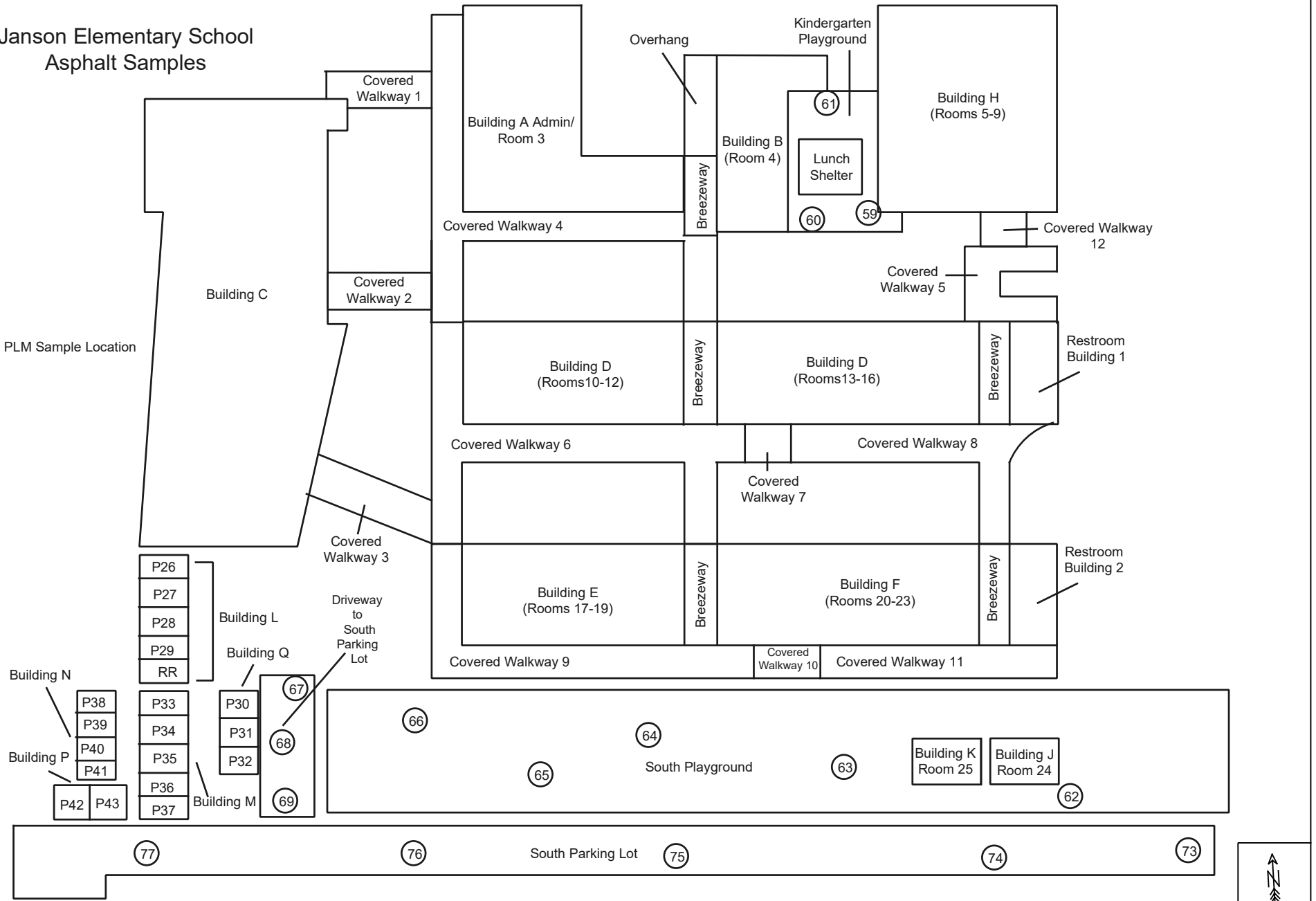

Client: Rosemead SD

Project #: 20-Z0046-0134

Info: PLM Sample Location



EXECUTIVE ENVIRONMENTAL
HEALTH & SAFETY SIMPLIFIED

Site: Janson Elementary School
Address: 8628 Marshall Avenue
Rosemead, California, 91170

Drawing Not to Scale - © 2012

Portables
Building K and Building J
Exterior



Client: Rosemead SD

Project #: 20-Z0046-0134

Info: No PLMs Collected



EXECUTIVE ENVIRONMENTAL
HEALTH & SAFETY SIMPLIFIED

Site: Janson Elementary School
Address: 8628 Marshall Avenue
Rosemead, California, 91170

Drawing Not to Scale - © 2012

Portables
Building L
Exterior

Room 26

Room 27

Room 28

Room 29

Restroom



Client: Rosemead SD

Project#: 20-Z0046-0134

Info: No PLMs Collected



EXECUTIVE ENVIRONMENTAL
HEALTH & SAFETY SIMPLIFIED

Site: Janson Elementary School
Address: 8628 Marshall Avenue
Rosemead, CA 91770

Drawing Not to Scale - © 2012

Building Q (Portables 30 through 32)
Exterior

Room 30

Room 31

Room 32



Client: Rosemead SD

Project#: 20-Z0046-0134

Info: No PLMs Collected



EXECUTIVE ENVIRONMENTAL
HEALTH & SAFETY SIMPLIFIED

Site: Janson Elementary School
Address: 8628 Marshall Avenue
Rosemead, CA 91770

Drawing Not to Scale - © 2012

Building M
Portables

Room 33
(Media Center onsite)

Room 34
(Library onsite)

Room 35

Room 36

Room 37



Client: Rosemead SD

Project#: 20-Z0046-0134

Info: No PLMs Collected



EXECUTIVE ENVIRONMENTAL
HEALTH & SAFETY SIMPLIFIED

Site: Janson Elementary School
Address: 8628 Marshall Avenue
Rosemead, CA 91770

Drawing Not to Scale - © 2012

Building N (Portables 38 through 41)
Exteriors

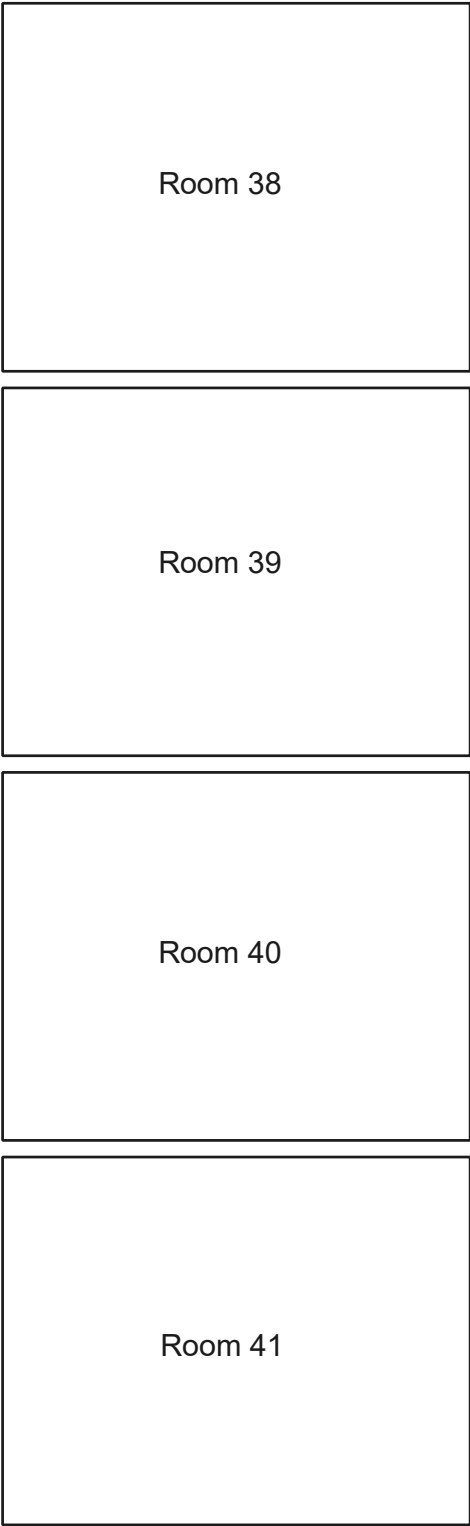

Building P
Exterior

Room 43



Client: Rosemead SD

Project #: 20-Z0046-0134

Info: No PLMs Collected



EXECUTIVE ENVIRONMENTAL
HEALTH & SAFETY SIMPLIFIED

Site: Janson Elementary School
Address: 8628 Marshall Avenue
Rosemead, California, 91170

Drawing Not to Scale - © 2012

APPENDIX C – STAFF CERTIFICATION

State of California
Division of Occupational Safety and Health
Certified Asbestos Consultant

Rhys D Kuzmic

Name



Certification No. **09-4586**

Expires on **01/20/21**

This certification was issued by the Division of Occupational Safety and Health as authorized by Sections 7180 et seq. of the Business and Professions Code.